

2024

Midwest

NORTH DAKOTA STATE FAIR

JULY
19-27
2024



STATIC



FRIDAY, JULY 19



SUNDAY, JULY 21



TUESDAY, JULY 23

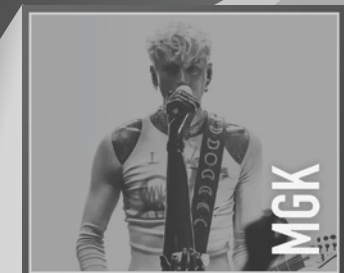

THURSDAY, JULY 25

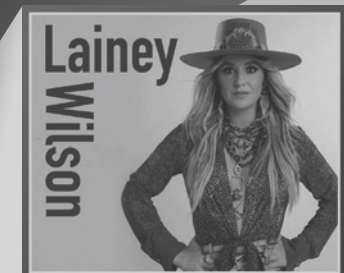

SATURDAY, JULY 27



4-H & FFA EVENTS

COMPETITIVE EXHIBITS

7 FREE STAGES!



SATURDAY, JULY 19



MONDAY, JULY 22



WEDNESDAY, JULY 24

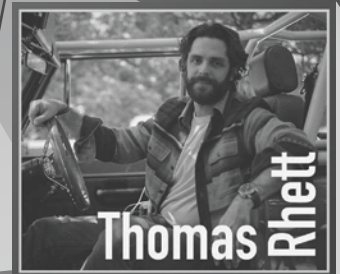

THURSDAY, JULY 26

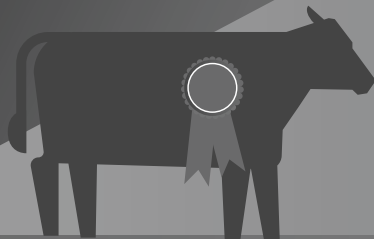
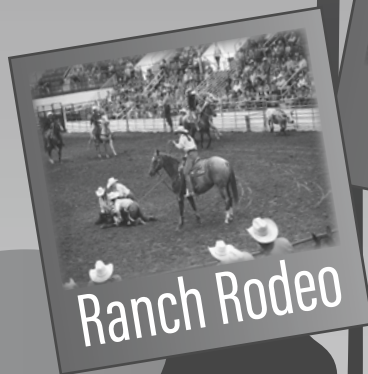

Get your FAIR on!

We are **PROUD** to be the

Exclusive Beverage Partner

of the North Dakota State Fair!



These brands
and more
distributed by

**NORTHERN
BOTTLING**

Check out our website at
www.gopepsind.com



Follow us on Facebook
@pepsiofminot



Welcome to the 2024 North Dakota State Fair, where North Dakotans from every corner of the state and visitors from around the world come together to celebrate our state's storied history, vibrant culture and cherished traditions.

The North Dakota State Fair embodies our gratitude for all that makes our state remarkable, from our thriving industries to our bountiful natural resources and the spirit of innovation that defines our people. With thousands of exhibits from 4-H and FFA members, alongside a diverse array of innovative products from North Dakota entrepreneurs and captivating works from local artists and craftspeople, there's something for everyone to enjoy. As you explore the fairgrounds, you'll witness the enduring legacy of agriculture through exhibits showcasing the latest advancements in farming technology, livestock competitions highlighting the skill and expertise of our agricultural community and educational displays illuminating the importance of agriculture in our daily lives.

As you enjoy the 59th North Dakota State Fair, seize the opportunity to immerse yourself in the extraordinary exhibits, exhilarating carnival rides and an impressive lineup of entertainment. From the friendships forged to the memories created, this summer tradition provides each attendee with the chance to embrace the spirit of North Dakota and Be Legendary.

Once again, the North Dakota State Fair promises fun and excitement for visitors and North Dakotans of every age. Now summer is finally here!

Enjoy!

Doug Burgum
Governor



Governor
Doug Burgum



Ag Commissioner
Doug Goehring

INDEX

Ag. Products.....	51-54
Beef.....	18-22
Boer Goats	39-41
Camping Information.....	10-11
Dairy	23-26
Dairy Goats	42-43
Drug Screen Policy	7
Education	74-75
Exhibitor Sweatshirts	47
Fair Dates	16
Fine Arts & Crafts	58-61
Foods.....	62-65
General Fair Information	5
Health Regulations.....	14-15
How to Enter your Exhibit.....	12-13
IAFE Code of Ethics	9
Livestock Exhibitor Rules.....	6-7
Livestock Schedule	17
Needlework	66-71
Pass Information	8
Photography	72-73
Plants & Flowers.....	55-57
Poultry.....	44-46
Rabbits	36-38
Sheep.....	30-35
Static Entry Form.....	49-50
Static Exhibits Information	48
Swine.....	27-29
Tile the State Fair.....	47
Trailer Parking	8
Veterinarian Schedule	15
Writing Contest	76

COMMISSIONER
DOUG GOEHRING



NORTH DAKOTA
DEPARTMENT OF AGRICULTURE
STATE CAPITOL
600 E. BOULEVARD AVE. – DEPT. 602
BISMARCK, ND 58505-0020

ndda@nd.gov
www.ndda.nd.gov

Dear Friends and Neighbors,

Welcome to the 2024 North Dakota State Fair!

One of North Dakota's biggest statewide events, the State Fair showcases agriculture at its finest. For more than half a century, FFA and 4-H members have been showcasing their hard work, dedication and talents at the fair; I know this year will be no different. Many have spent long hours nurturing and growing crops and livestock, designing and building outstanding exhibits, creating beautiful artwork, writing thoughtful essays and much more. This is a place to showcase the youth of our state and their accomplishments, to recognize them for their contributions and encourage them to continue their involvement in agriculture.

You can also see innovations in the world of agriculture technology and equipment. Investigate everything from state-of-the-art computer software to the latest and largest combines, tractors and other implements. Seeing this equipment gives you a first-hand look at some of the things it takes to farm and ranch in today's world.

Kids and adults alike will enjoy getting a close-up view of different crops at the crop plot, watching the racing pigs, attending a rodeo or watching bull riding.

Mark your calendar for Monday, July 22 from 11 am – 1 pm to enjoy a \$1 Pride of Dakota lunch. It's all under the Festival Tent in the State Fair Park.

State Fair Manager Craig Rudland and his staff work hard to make sure your experience at the 59th annual North Dakota State Fair, July 17-27, is educational, entertaining and most importantly memorable. Come out and enjoy the fair, it will be worth it!

Sincerely,

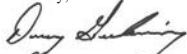

Doug Goehring
Agriculture Commissioner

North Dakota State Fair BOARD OF DIRECTORS



Gary Knell (Hazen)
President



Kelly Hanson (Hannaford)
Vice President



Kandi Mikkelsen (Minot) Secretary



Lee Ann Karsky (Dickinson) Treasurer



Travis Bell (Fordville)



Breana Kiser (Ellendale)



Connie Hanson (Devils Lake)



Mark Schaunaman (Ashley)



Ron "Bing" Bingeman (Williston)



Craig Rudland

North Dakota State Fair STAFF MEMBERS



Aaron Ottmar



Lucas Adams



Dar Brown



Dan Christensen



Logan Christensen



Nickolas Cimino



Bruce Clark



Darin Clark



Kyler Fjeld



Daryl Fry



Ricky Gilmore



John Gleich



Kaitlyn Godejohn



Derek Hancock



Laci Hanson



Stephen Kenny



Dave Lommen



Patrick Meek



Jamisen Ogle



Shelly Parish



Mike Popham



Char Ratliff



Joel Rhoads



Devin Ritchie



Jesse Strandberg

GENERAL FAIR INFORMATION

CONTACT INFORMATION:

Mailing Address: PO Box 1796, Minot, ND 58702
Physical Address: 2005 Burdick Expressway East, Minot, ND 58701
State Fair Office Phone: (701) 857-7620
Camping Office Phone: (701) 838-1193
Ticket Office Phone: (701) 852-FAIR
Email: competitive@ndstatefair.com
Website: ndstatefair.com

BUILDING HOURS:

State Fair Office 8 AM - 9 PM
FFA, 4-H, Magic Place 10 AM - 9 PM
Flickertail Gardens 11 AM - 1 AM (Sunday 12 PM - 1 AM)
Carousel Pub 12 PM - 1 AM
Viggy's Restaurant 10 AM - 9 PM
Commercial Building I & III 11 AM - 10 PM
Commercial Building II 10 AM - 9 PM

2024 INFORMATION:

1. The North Dakota State Fair for 2024 will be open to the public at 8:00 a.m.
2. Competitions are open to everyone unless otherwise stated.
3. During the Fair, the grounds will be kept and equipped to the best of our ability and resources for the comfort of the public.
4. A first aid station will be maintained at the Ambulance Station located at **Gate E** for use in case of accident or illness.
5. An information desk will be maintained in the Media Center in front of Commercial I.

The management will consider it a favor if persons will report any mistreatment or extortion practice by any employee of the Fair or concessionaires. DO NOT WAIT until the Fair is over to file a complaint, DO IT AT ONCE!

GENERAL RULES AND REGULATIONS:

1. The North Dakota State Fair Board reserves the final and absolute right to interpret these rules and regulations, and settle and determine all matters, questions and differences in regard thereto, or otherwise arising out of, connected with, or incident to the Fair.
2. Removal time of exhibits is specified in each department.
3. Exhibits not removed or arrangements made for their removal within ten days of close of Fair will become property of the Fair.
4. The board reserves the right to reject any entries offered, particularly such as require an unreasonable amount of space.
5. Exhibitors are required to give attention to their exhibits, and at the close of the Fair, to attend promptly to their removal.
6. The board will carefully guard against extortion in any form practiced on patrons of the Fair. A violation of this rule shall cause forfeiture of contract and money paid and involves expulsion from the grounds as the secretary of the board may direct.
7. The board reserves the right to formulate and announce new rules to meet emergencies that may arise later and during the Fair, and to adjudicate all matters arising from the Fair after it is held.
8. The board reserves the right to direct and regulate the parking of all automobiles or other vehicles or conveyances within the Fairgrounds and to direct where they shall be driven therein. It may prohibit the running of automobiles in any section of the grounds whenever, in its opinion, common safety demands it.
9. The Fair management and board reserve the right to exclude from the Fairgrounds any person or persons whom they may deem undesirable, or who shall violate any of the rules laid down by the management, or who shall otherwise become offensive.
10. No rollerblades or bicycles allowed on Fairgrounds.
11. Only livestock and/or horse exhibitors will be allowed to have dogs on the Fairgrounds in camping areas only. Under NO circumstances will dogs be allowed south of the barns.
12. No refunds of entry fees will be made unless cancellation is received **IN WRITING** (letter, fax or email) by July 1. No refunds will be given on tickets, wristbands or vehicle permits.
13. All livestock shows not produced by the North Dakota State Fair must have State Fair Board approval by June 15 for any sponsor they plan to recognize during State Fair.

NO LIABILITY:

1. Every possible protection and courtesy will be extended to the public, concessionaires and exhibitors at the North Dakota State Fair, but the board shall not be responsible for any loss of exhibits, animals, or equipment in case of fire, theft, or from loss from any other cause.
2. The North Dakota State Fair Board, its agents, servants, and employees shall not be held liable in case of injury to exhibitors, concessionaires, or the public on the grounds or in the buildings from any cause whatsoever while on the grounds of the North Dakota State Fair.
3. All entries including livestock, horse, static, etc. are brought to the state fairgrounds and remain under the exhibitor's own risk.

2024 DATES & LOCATIONS OF FAIRS & CELEBRATIONS

FOR MORE INFORMATION:

Tera Heiser, Secretary
 PO Box 181, West Fargo, ND 58078 • 701-866-4907
secretary@heartlandassociationffe.com • www.heartlandassociationffe.com

MARCH 2024

Date: March 6-10
 Event: North Dakota Winter Show - Valley City

JUNE 2024

Date: June 13-16
 Event: Bottineau County Fair - Bottineau

Date: June 13-16
 Event: Wells County Fair - Fessenden

Date: June 14-16
 Event: McLean County Fair – Underwood

Date: June 15-July 7
 Event: Stark County Fair/Roughrider Days - Dickinson

Date: June 16-18
 Event: Divide County Fair - Crosby

Date: June 16-18
 Event: McKenzie County Fair - Watford City

Date: June 19-22
 Event: Foster County Fair – Carrington

Date: June 19-23
 Event: Greater Grand Forks Fair - Grand Forks

Date: June 22-27
 Event: Ramsey County Fair– Devils Lake

Date: June 26-29
 Event: Stutsman County Fair - Jamestown

Date: June 26-30
 Event: Upper Missouri Valley Fair - Williston

Date: June 27-30
 Event: Pierce County Fair- Rugby

Date: June 28-30
 Event: Dunn County Fair – Killdeer

Date: June 28-July 14
 Event: Red River Valley Fair – West Fargo

JULY 2024

Date: July 10-13
 Event: Kidder County Fair - Steele

Date: July 10-14
 Event: Griggs County Fair - Cooperstown

Date: July 10-14
 Event: Mercer County Fair – Beulah

Date: July 11-13
 Event: Pembina County Fair – Hamilton

Date: July 11-13
 Event: Golden Valley County Fair- Beach City

Date: July 11-14
 Event: Dickey County Fair - Ellendale

Date: July 11-14
 Event: Bowman County Fair – Bowman

Date: July 11-14
 Event: Tri-County Fair – Wishek

Date: July 11-14
 Event: Hettinger County Fair – Mott

Date: July 19-27
 Event: North Dakota State Fair- Minot

Date: July 25-28
 Event: Sargent County Fair - Forman

Date: July 31 - August 4
 Event: Morton County Fair - New Salem

AUGUST 2024

Date: August 1-3
 Event: Adams County Fair - Hettinger

Date: August 15-18
 Event: Grant County Fair - Carson

Date: August 20-25
 Event: Ransom County Fair - Lisbon

SEPTEMBER 2024

Date: September 8th
 Event: Aronia Berry Harvest Festival - Amenia, ND

OCTOBER 2024

Date: October 17-19
 Event: Walsh County Fair - Park River

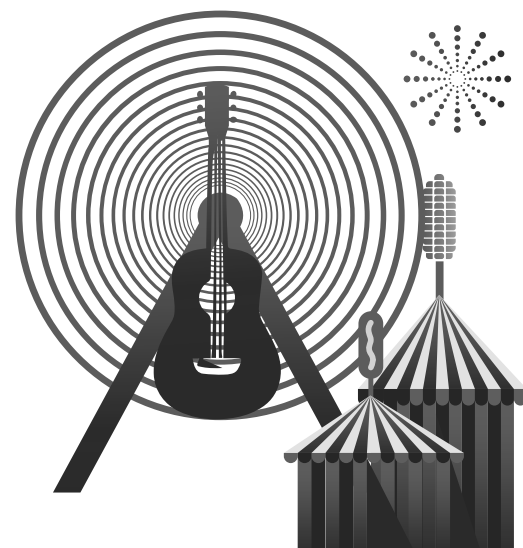

Tile the State Fair Center!

Leave your mark on the North Dakota State Fair by purchasing a tile. Each tile can be engraved with a family name, logo, or any other text.



The North Dakota State fair Foundation exists to preserve and enhance the North Dakota State Fair, and all that it encompasses, for posterity.
With your support we can continue to offer and improve upon the programs, facilities, rich tradition, and therefore experiences, that only the North Dakota State Fair can offer.

www.ndstatefairfoundation.com



Name _____
Address _____
City _____ State _____ Zip _____
Phone _____
Email _____
Tile: \$500
Message (25 Characters or less) _____

Payment: Check enclosed (payable to ND State Fair Foundation)
MasterCard Visa Discover American Express
Credit Card Number _____
Expiration Date _____ Security Code _____
Cardholder Signature _____

Please return to ND State Fair Foundation
PO Box 1796, Minot, ND 58702

EXHIBITOR SWEATSHIRTS

**Free sweatshirt to all competitive entries:
FFA, 4-H, Livestock,
& Static**



Only the exhibitor may pick up their sweatshirt at the ND State Fair office in the State Fair Center between 10am & 4pm, July 19-27, 2024

While Supplies Last

Static Exhibits Information

STATIC EXHIBITOR INFORMATION:

- Entries must be made on the furnished entry blanks or online at ndstatefair.fairwire.com, online entry is the preferred method. All entries need to be filled out properly and given all information asked. **Write legibly.**
- **Entries will close July 6 at 5pm.**
- Use a separate entry blank for each department (i.e. - fine arts & crafts, needlework, etc.) Please label each exhibit with division and class number, as well as exhibitor's name and contact information.
- All exhibitors are expected to read the IAFE Code of Ethics. Submission of entry implies acceptance of and compliance with these conditions and regulations.
- Canadian exhibitors at par for entry and stall fees, compliments of ND State Fair
- Those picking up exhibits on the last Saturday of the fair, must pay for gate admission.

JUDGING/PREMIUMS:

- Judges will not act in any partial way toward any of the exhibits or exhibitors. Judges will not be allowed to have entries in a division where he/she is the judge.
- Any person who shall attempt to interfere with or influence the judges while in the discharge of their duties, or shall at any time on the grounds of the Fair use contemptuous or abusive language to any judge, or within the hearing, in consequence of any awards made by him, shall forfeit his right to any premiums he/she may have won, and may be excluded from the grounds. Judges are requested to report any infraction of this rule.
- Cash awards will be mailed September 2024.
- Premiums will be paid as soon as it is possible to check over the records and judge's report.
- Checks that are issued for premiums must be cashed promptly.
- Awards will be designated by proper colored cards and ribbons as follows: Blue for first, red for second, white for third, pink for fourth, yellow for fifth, green for sixth and purple for championships.
- State Fair has confirmed the intent of all premium sponsors, but assumes no guarantee of their commitment.
- Judges need not make awards in classes where competition is lacking
- In classes where there is but one entry, placing will be awarded at the discretion of the judge.

SUPERINTENDENTS:

- Superintendents of the various departments will be designated by suitable badges and attire.
- Each superintendent will have full charge of his or her department with authority to select all assistants and helpers, unless otherwise provided, subject to approval of the management or directors.
- All claims and payrolls must be certified by the superintendent and filed with the Fair office.
- Each superintendent must take charge of the books and return same promptly to the secretary's office as soon as each class is judged. No changes will be allowed in the judges' books unless on order of the board. All orders for premiums must be made out and signed by the superintendent and countersigned by secretary before they will be honored.
- It shall be the duty of the superintendent at the close of the Fair to furnish a report in detail giving full information on exhibitors and entries entitled to special premiums, also give the number of exhibitors and entries in each class.
- The superintendent of each division will have charge of the exhibits in his/her division and of the assistants and attendants employed there. Requests and complaints should be made through the superintendent. Exhibitors should confer daily with the superintendents of their divisions.
- The superintendent of each department will have information as to the time and place at which judging will be done. Exhibitors will be expected to secure this information from the division superintendents.

PROTEST:

- All protests must be made in writing within five hours to the management after the award has been made, it being considered that an award is made when the notation of the decision of the judge is entered in the department award book.
- All protests must be accompanied by a deposit of \$25 in the Livestock Department and \$10 in all other departments, which shall be returned to the complainant if sustained, and if the protest shall not be sustained, then said sum shall be forfeited.
- No protest or appeal based upon the statement that the judge or judges are incompetent or have overlooked an animal or article, will be considered by the management or the board of directors.
- Protest must state plainly the cause of complaint or appeal, with specific charges and recital of facts relied upon by the rule violated, naming witnesses and their addresses by whom proof is to be made.
- All questions in dispute or differences not covered by these rules shall be referred to the Governing Board of Directors whose decision shall be final.

NEW TO THE STATIC DEPARTMENT

We are excited to offer a theme for the entire static department for the 2024 fair! This year's theme is "Up, Up, & Away". Please view the class listing under the respective division to see if the theme class applies. After the department judging has taken place, we will pull all the first place exhibits that are entered in the theme classes. The first place themed exhibits will be placed in one display and we will title one exhibit as the "Best of Theme" Be creative! We can't wait to see what you come up with!

NEW CLASS:

Don't throw those graduation caps away, you have a chance to receive premium dollars for it!

You can enter them under Department 111, Division H, Class 24

ENTRY FORM: Departments 109 – 114

(Ag Products, Plants & Flowers, Fine Arts & Crafts, Foods, Needlework, Photography)

Please use separate entry forms for each department entered

Return completed entry to:
Check one department

North Dakota State Fair
PO Box 1796 • Minot, ND 58702

- Department 109: Agriculture Products
- Department 110: Plants & Flowers
- Department 111: Fine Arts & Crafts
- Department 112: Foods
- Department 113: Needlework
- Department 114: Photography



Name of Exhibitor _____

Mailing Address _____

City _____ State _____ Zip Code _____

Daytime Phone _____ Cell Phone _____

Email _____

(Please include as much information as possible in case we need to contact you regarding your entry.)

Please accept the entries of article indicated below for exhibition at the North Dakota State Fair, subject to the rules and classifications published in the premium listing, by which I hereby agree to be governed, and I further declare that all statements made in connection with said entries are true. No entries will be accepted unless filed with the ND State Fair office before the closing date. I have carefully read the rules of entry.

Signature of Exhibitor _____ Date _____

Check here if under 21 years of age.

Division	Class	Article Use wording of premium listing to describe each entry	Fee

Total Number of Exhibits (this side) _____

Total Fees (this side) _____

You may photocopy this form or download additional forms at www.ndstatefair.com.

Division	Class	Article	Fee

Total Number of Exhibits (this side) _____ Total Fees (this side) _____

You may photocopy this form or download additional forms at www.ndstatefair.com.

Department 109 - Ag. Products

Superintendents: *Hadley Magilke & Ashley Bachmeier*

Ag. Products Schedule

	<u>Drop Off</u>	<u>Judging</u>	<u>Pickup</u>
First Show	Day 1: Wednesday - 7/17 - 1-5pm	Thursday - 7/18	Monday - 7/22 - 7-9pm
	Day 2: Thursday - 7/18 - 8am-12pm		
Second Show	Tuesday - 7/23 - 8-11am	Tuesday - 7/23	Saturday - 7/27 - 10am-2pm

Deadline for entry form is July 6, 2024. Open class crops and gardens are shown in the 4-H Hall in the ND State Fair Center. There are two shows, beginning Friday, July 19 and Tuesday, July 23, to ensure fresh displays.

ENTRY FEE: None

WHO MAY ENTER:

- Any North Dakota resident — farmer, gardener or seed grower may be an exhibitor, but no person shall be permitted to enter more than one exhibit in any one class, nor shall members of the same family living on the same farm or household be permitted to compete in the same class. Exhibits must have been raised and owned by the person entering them.

HOW TO ENTER:

- Entries must be listed on an official entry form by July 6. Due to our computer entry program, we encourage you to mail your entry form in early. Please clearly print name, address, department, division, and class on the entry form, as well as on the sample being exhibited. There is also an online entry option that can be found on ndstatefair.com.
 - Variety should be listed with the name of each sample.** Entry blanks are available in this book. Use separate entry blanks for each department (i.e. Fine Arts, Needlework, etc.); you may photocopy the entry form. A gate pass for an auto, driver and one passenger, good for the necessary times and dates of entry and change-over only, will be provided. Abuse of this pass will result in discontinuation. Entries must be received by entry deadline to qualify for this pass. The any other crop/produce class in various sections is included to make provision for exhibiting other named crop/produce which are less commonly grown. All crop/produce in a given class competes with each other for places but will be judged on the basis of individual merit with respect to the particular crop/produce.

DROPPING OFF:

- Exhibits may be mailed to the ND State Fair or brought to the 4-H Hall. The Fair management is not bound to take entries made after noon Thursday, July 18 for the first show and after 11am on Tuesday, July 23 for the second show. See special information governing show period for vegetables and garden produce.

JUDGING CRITERIA:

- At judging ribbons will be attached, except the special information governing the second show period for vegetables and garden produce. Instructions on size of exhibits are given under each division. Follow these closely; exhibits of less than the required amount will not be considered for premiums. Treating entries with oil chemicals or processing in any way injurious to the exhibit is not permitted. The judges are instructed not to award premiums to entries unfit for the show or those incorrectly named.
 - This a Produce Show:** only high quality material should be exhibited. The show management reserves the right to reject any exhibits which are determined undesirable. 4-H and FFA Pure Seed members should make duplicate exhibits if they wish to enter open class.
 - Return of samples:** Exhibits may be picked up between 7 p.m. and 9 p.m. on the last day of each show. After 9 p.m., they will be disposed of. Exhibits will be returned to the exhibitor at exhibitor's own expense if request is made before the close of the show.
 - The Fair reserves the right to color any sample. This will not injure the growing qualities of the sample, but is a precedent followed by all leading Fairs in the country. The show management will exercise reasonable precaution with all items but will not be responsible for loss of or mixture of samples. All exhibits must remain in place for each show as specified. Ribbons must remain on the exhibits during the entire show. All exhibits will become the property of the Fair unless claimed by 9 p.m. Saturday, July 27.
- Blue ribbon winners of the First Show or members of the same farm or household may not re-enter that a same class for the Second Show. Exhibitors are required to collect their own containers at the end of each show period in which they have exhibited.

Cash awards will be mailed September 2024

DIVISION A - GRAIN & FORAGE BUNDLES

To make small grain, grasses, and millet sheaves entered for seed production: Select uniform high quality plants. Spread the grain plants out in a sheltered area and allow to dry for one day. Strip off all leaves, taking care not to break the straw in handling. Form a core of 30 to 40 stems, then place the other stems around the core to form a sheaf 7-9 inches in circumference (around) at a point halfway between the heads and the butt. Tie the bundle firmly in three places, using cord which will not cut the straw. Form the crown (heads) in a rounded shape by moving the core up and down. Cut off the butt squarely and hang the sheaf with heads down until exhibited.

To make alfalfa and sweet clover sheaves entered for seed production: Use same guidelines as for forage production; select stalks showing maximum seed development.

To make a sunflower sheaf: The entire plant should be shown with the leaves removed.

Seed Production Sheaf

Premiums: \$17.00 • \$15.00 • \$13.50

CLASS

1. Any hard red spring wheat
2. Any Durum Wheat
3. Safflower
4. Any barley variety
5. Any oat variety
6. Any flax variety
7. Any rye variety
8. Millet for seed
9. Sweet clover for seed
10. Alfalfa for seed
11. Bromus for seed
12. Crested wheat grass for seed
13. Sunflower, 6 stalks
14. Canola
15. Any other crop seed

To make a forage sheaf: Select the leafiest types to be found in the field and cut close to the ground. Do not strip a single leaf or branchlet from the stem as forage should retain its color and leaves. In making up show bundles, select those individual stems that have retained the most and best leaves with their color. Make bundles from 3 to 5 inches in diameter (across) or 9.4 to 11 inches in circumference (around) tied securely once at a point 1/3 from the base, and tied a second time loosely once about halfway up to prevent spreading. Sheaves measuring under 9.4 inches in circumference will be disqualified. Corn, Sudan, Sorghum and Millet sheaves shall be tied three times at uniform spacing.

Forage Production Sheaf

Premiums: \$17.00 • \$15.00 • \$13.50

CLASS

16. Crested wheat grass forage
17. Sudan grass forage
18. Corn forage, 6 stalks
19. Bromus forage
20. Alfalfa forage
21. Sweet clover forage
22. Sorghum forage
23. Millet forage
24. Any other variety forage

The North Dakota Wheat Commission

on behalf of the North Dakota Wheat Producers and in recognition of outstanding wheat sample preparation, North Dakota Wheat Commission offers the following additional premiums for wheat and durum exhibits:

NORTH DAKOTA WHEAT COMMISSION
Building Bigger Better Markets

1st - \$40 2nd - \$30 3rd - \$25

DIVISION B - FIELD CROPS & GRAINS

Grains, grasses, corn and legume exhibits must have been grown by the exhibitor in the State of North Dakota in 2023 and 2024. Minimum requirements - grains, grasses, legumes or flax - one quart, corn - six ears. Variety name must be listed on classes 1-7.

Premiums: \$17.00 • \$15.00 • \$13.50

CLASS

- | | | |
|--|---|---|
| <ol style="list-style-type: none"> 1. Any variety of HRS wheat 2. Any variety of durum wheat 3. Any variety of flax 4. Malting barley 5. Feed barley 6. Any variety oats 7. Any variety rye 8. Alfalfa 9. Sweet clover 10. Brome grass 11. Field corn (6 ears, husks removed) | <ol style="list-style-type: none"> 12. Yellow mustard 13. Crested wheat grass 14. Other garden or field beans 15. Pinto beans 16. Navy beans 17. Winter wheat 18. Millet | <ol style="list-style-type: none"> 19. Sunflower (oil variety) 20. Sunflower (confectionery variety) 21. Field corn (shelled) 22. Any variety of soybean 23. Safflower 24. Canola 25. Any other crop |
|--|---|---|

The North Dakota Wheat Commission

on behalf of the North Dakota Wheat Producers and in recognition of outstanding wheat sample preparation, North Dakota Wheat Commission offers the following additional premiums for wheat and durum exhibits:

NORTH DAKOTA WHEAT COMMISSION
Building Bigger Better Markets

1st - \$40 2nd - \$30 3rd - \$25

DIVISION C & D - VEGETABLES & FRUIT PRODUCE

- Vegetables must have been grown by the exhibitor in North Dakota in 2024. Exhibits must consist of that part of the plant commonly used for human consumption.
- An auto and one passenger pass, good for the necessary times and dates of entry and change-over only, will be provided for this year's Fair. Abuse of this pass will result in discontinuation for 2024. The gate at the NW end of the Fairgrounds and the door at the NW corner of the Theater shall be unlocked and manned for your delivery and pick-up convenience.
- There will be two show periods for this division

DIVISION C - VEGETABLES

Vegetables will be judged on the following criteria: uniformity, maturity, correct number and preparation, full size, good color and shape, firm, free of damage by insects, disease or mechanical injury.

Beans: Exhibit 12 pods with calyx (stem).

Beets: May wash, tops one to one and one-half inches long, leave tap root. Exhibit six beets.

Broccoli: Over three inch head diameter, remove all leaves, head and stock six to eight inches long. Exhibit one head.

Cabbage: Do not peel excessively, leave layers of sound green outer leaves, but loose leaves should be removed. Trim root smooth with the base of the leaves. Exhibit one head.

Carrots: Top one to one and one-half inches long, may wash and leave tap root. Exhibit six carrots.

Cauliflower: Trim leaves even with outer edge of head, remove older leaves, cut stem 1" below base of the head. Exhibit one head.

Celery: Trim leaves uniformly, cut roots even with stock. Exhibit one plant.

Cucumbers: Wipe clean, leave half inch stem.

Dill: Trim to a four inch stem. Exhibit six, seed bearing heads tied together at 1" from the base.

Eggplant: One inch of stem attached. Exhibit one specimen.

Garlic: One inch stem, trim root to one inch of bulb. Exhibit six garlic.

Kohlrabi: Cut root off at base. Cut off all leaves to within approximately one and one half inches of the bulb. Exhibit three kohlrabi.

Lettuce (head): Trim older outer leaves, remove root. Exhibit one plant

Muskmelons: Stems removed, exhibit one melon.

Onions (red, yellow, and white): Remove all dead layers of skin, clean but do not wash, leave one to one and one-half inch stem; however, do not injure bulb, trim root to 1/4 inch. Exhibit six onions.

Onions (green): Remove outer covering on bulb, trim tops so overall length is six to eight inches, trim root 3/4 inch of bulb. Exhibit six onions.

Parsnips: Cut tops one to one and one-half inches, leave tap root. Exhibit three parsnips.

Peas: 12 pods with calyx (stem).

Peppers: Leave one-half to one inch stem. Exhibit three peppers.

Potatoes (red, white or russet): Brush or wipe off with soft cloth, can be washed but do not scrub. Exhibit six potatoes.

Radishes (globe or icicle): Leave one-half inch top growth and tap root. Exhibit six radishes.

Rhubarb: Trim so two inches of leaf blade remains attached to stalks, do not remove ends. Tie six stalks at each end and center. Exhibit one bunch.

Rutabaga: Cut tops to one to one and one-half inches, leave tap root. Exhibit three rutabagas.

Squash, other: Normal harvest size, leave stem, exhibit one.

Summer Squash: Zucchini type, maximum eight inches long, leave stem. Exhibit three.

Sweet Corn: Do not remove husks, trim silk to within one inch of top of husk, shank one to two inches long. Exhibit three ears.

Swiss Chard: Use three plants, trim older outer leaves, leave root, wrap root in wet paper and cover with plastic.

Tomatoes: Remove stems. Exhibit six larger fruits or 12 cherry types.

Turnips: Cut tops one to one and one-half inches, leave tap root. Exhibit three turnips.

Watermelon: One to one and one-half inch stem, exhibit one melon.

DIVISION D - FRUITS

All fruits shown must be raised by the exhibitor in North Dakota and proof of the same may be required.

All fruit classes: remove stems except strawberries. Grapes should be displayed in clusters.



Enter Online:
www.ndstatefair.com

You may make your entry on this page for Department 109, Division C Vegetables and Division D Fruits. Please keep a copy for your records.

ENTRY FORM: Department 109, Divisions C and D
Return completed entry to: North Dakota State Fair, PO Box 1796, Minot, ND 58702

Name of Exhibitor _____

Address _____ City _____ State _____ Zip Code _____

Daytime Phone _____ Cell Phone _____ Email _____

(Please include as much information as possible in case we need to contact you regarding your entry.)

Please accept the entries of articles indicated below for exhibition at the North Dakota State Fair, subject to the rules and classifications published in the premium listing, by which I hereby agree to be governed, and I further declare that all statements made in connection with said entries are true. No entries will be accepted unless filed with the ND State Fair office before the closing date. I have carefully read the rules of entry.

Signature of Exhibitor _____ Date _____

Check here if under 21 years of age.

Division C - Vegetables

Premiums: \$14.50 • \$13.50 • \$12.50

1st Show Class

- 1.
- 2.
- 3.
- 4.
- 5.
- 6.
- 7.
- 8.
- 9.
- 10.
- 11.
- 12.
- 13.
- 14.
- 15.
- 16.
- 17.
- 18.
- 19.
- 20.

2nd Show Class

- 101. Beans - green pods 12 pods
- 102. Beans - wax pods 12 pods
- 103. Beets - 6 beets
- 104. Broccoli - 1 head
- 105. Cabbage - 1 head
- 106. Carrots - table 6 carrots
- 107. Cauliflower - 1 head
- 108. Celery - 1 plant
- 109. Cucumbers, slicing - 3 cucumbers
- 110. Cucumbers, pickling - 3 cucumbers
- 111. Dill - 6 seed heads
- 112. Eggplant - 1 specimen
- 113. Garlic - 6 bulbs
- 114. Kohlrabi - 3 bulbs
- 115. Lettuce, head - 1 head
- 116. Muskmelons - 1 melon
- 117. Onions, green - 6 onions
- 118. Onions, red - 6 onions
- 119. Onions, white - 6 onions
- 120. Onions, yellow - 6 onions

1st Show Class

- 21.
- 22.
- 23.
- 24.
- 25.
- 26.
- 27.
- 28.
- 29.
- 30.
- 31.
- 32.
- 33.
- 34.
- 35.
- 36.
- 37.
- 38.
- 39.
- 40.
- 41.
- 42.

2nd Show Class

- 121. Parsnips - 3 roots
- 122. Peas, green pods - 12 pods
- 123. Peas, edible pods - 12 pods
- 124. Peppers, bell - 3 peppers
- 125. Peppers, others - 3 peppers
- 126. Potatoes, red - 6 potatoes
- 127. Potatoes, russet - 6 potatoes
- 128. Potatoes, white - 6 potatoes
- 129. Radish, globe - 6 radishes
- 130. Radish, icicle - 6 radishes
- 131. Rhubarb - 6 stalks
- 132. Rutabaga - 3 roots
- 133. Squash, summer - 3 squash
- 134. Squash, other - 1 squash
- 135. Sweet Corn - 3 ears
- 136. Swiss Chard - 3 plants
- 137. Tomatoes - 6 large
- 138. Tomatoes - 12 cherry
- 139. Turnips - 3 root
- 140. Watermelons - 1 melon
- 141. Any other Vegetable Reasonable amount
- 142. Theme Class- (See Static Information Page)

Division D - Fruits

Premiums: \$14.50 • \$13.50 • \$12.50

1st Show Class

- 1.
- 2.
- 3.
- 4.
- 5.

2nd Show Class

- 101. Apples - 6 fruits
- 102. Cherries (all varieties) - 1 pint
- 103. Choke Cherries - 1 pint
- 104. Crabapples - 12 fruits
- 105. Gooseberries - 1 pint

1st Show Class

- 6.
- 7.
- 8.
- 9.
- 10.
- 11.

2nd Show Class

- 106. Juneberries - 1 pint
- 107. Plums - 12 fruits
- 108. Raspberries - 1 pint
- 109. Strawberries - 1 pint
- 110. Any other Fruit - Similar size as fruit above
- 111. Theme Class- (See Static Information Page)

Department 110 - Plants & Flowers

Superintendents: Wanda Bachmeier & Karla Thompson

Plants & Flowers Schedule

	<u>Drop Off</u>	<u>Judging</u>	<u>Pickup</u>
First Show	Thursday - 7/18 - 7:30-10:30 am	Thursday - 7/18	Tuesday - 7/23 - 7-9 am
Second Show	Tuesday - 7/23 - 7:30-10:30 am	Tuesday - 7/23	Saturday - 7/27 - 6-8 pm
			Sunday - 7/28 - 10 am-2 pm

Deadline for entry form is July 6, 2024. Open Class Plants & Flowers may be brought to 4-H Hall in the ND State Fair Center. There are two shows, beginning Friday, July 19 and Tuesday, July 23, to ensure fresh displays.

ENTRY FEE: None

RULES ON ENTERING:

- Entries must be listed on an official entry form by July 6. Due to our computer entry program, we encourage you to mail your entry form in early. There is also an online entry option that can be found on ndstatefair.com.
- Please clearly print name, address, department, division, and class on the entry form, as well as on the sample being exhibited. Exhibits cannot be accepted unless an entry blank is properly filled out and on file with the Fair Office prior to the closing date for entries.
- Only one entry may be made in any one class from any one family except for Any Other class, where exhibitors may enter three varieties or pots in this class.
- List variety and name. For size of planters, measure pot diameter at the top, edge to edge.
- Class numbers 1-102 are for the first show, class numbers 101-202 are for the second show.
- Blue ribbon winners of the First Show or members of the same farm or household may not re-enter that a same class for the Second Show. Also, if first show results in a ribbon, the same plant cannot be re-entered in the second show
- The superintendent in charge will see that all plants on exhibition are properly cared for during the time of the Fair, but will not be responsible for loss or injury.

RULES ON DROPPING OFF:

- Entry tags will be mailed in advance of the first show so exhibitor can tag their own exhibits.
- The Fair management is not bound to take entries made after 10:30am Thursday, July 18 for the first show and after 10:30am on Tuesday, July 23 for the second show.
- A gate pass for an auto, driver and one passenger, good for the necessary times and dates of entry and change-over only, will be provided. Abuse of this pass will result in discontinuation for 2024. Entries must be received by entry deadline to qualify for this pass.
- Please enter the gate at the northwest end of the Fairgrounds; you may deliver and pick-up your entries through the FFA Hall.

JUDGING CRITERIA:

- Exhibitors must provide their own vases or other receptacles and place their exhibits in water or otherwise ensure their preservation. Foam only allowed in arrangements.
- **No exhibitors allowed in the hall during judging.**
- Authorized judges shall award ribbons and the decisions of these judges shall be final. Regardless of the number of entries in a division, prizes and ribbons will not be awarded to unworthy exhibits.
- One Best of Show ribbon will be awarded for each of the two shows.

RULES ON PICKING UP:

- All exhibits will become the property of the Fair unless claimed by 9 p.m. Saturday, July 27.
- Exhibitors are required to collect their own containers at the end of each show period in which they have exhibited.
- All exhibits must remain in place for each show period. Ribbons must remain on exhibits during the entire show period

SUGGESTIONS FOR DISPLAYING:

- | | |
|---|--|
| o Remove buds | o Use the right height and width of container for the arrangement. |
| o May have attached foliage and sufficient stems | o Lythrum is illegal: do not use in arrangements. |
| o Count the flowers, and do not crowd the flowers | o Outdoor planters may have other plants Lot 96-99 & 196-199 only. |
| o Keep petals out of water | |

Cash awards will be mailed September 2024.

Enter Online at:
www.ndstatefair.com

You may make your entry on this page for Department 110, Division A Annuals, Division B Perennials/Biennials, Division C Artistic Arrangements, and Division D Potted Plants.
Please keep a copy for your records.

ENTRY FORM: Department 110, Divisions A, B, C and D
Return completed entry to: North Dakota State Fair, PO Box 1796, Minot, ND 58702

Name of Exhibitor _____

Address _____ City _____ State _____ Zip Code _____

Daytime Phone _____ Cell Phone _____ Email _____

(Please include as much information as possible in case we need to contact you regarding your entry.)

Please accept the entries of articles indicated below for exhibition at the North Dakota State Fair, subject to the rules and classifications published in the premium listing, by which I hereby agree to be governed, and I further declare that all statements made in connection with said entries are true. No entries will be accepted unless filed with the ND State Fair office before the closing date. I have carefully read the rules of entry.

Signature of Exhibitor _____ Date _____

Check here if under 21 years of age.

Division A - Annuals
Premiums: \$14.50 • \$13.50 • \$12.50

- | 1st Show Class | 2nd Show Class | 1st Show Class | 2nd Show Class |
|------------------------------|---|------------------------------|--|
| <input type="checkbox"/> 1. | <input type="checkbox"/> 101. Bachelor Buttons, 8-12 blooms | <input type="checkbox"/> 22. | <input type="checkbox"/> 122. Petunias, singles, grandiflora, 5 blooms, over 2 -1/2" |
| <input type="checkbox"/> 2. | <input type="checkbox"/> 102. Bells of Ireland, 3 to 5 stems (Leave leaves on) | <input type="checkbox"/> 23. | <input type="checkbox"/> 123. Petunias, singles, multiflora, 5 blooms, 1 1/2 - 2- 1/2" |
| <input type="checkbox"/> 3. | <input type="checkbox"/> 103. Calendulas, singles/doubles, 5-7 blooms | <input type="checkbox"/> 24. | <input type="checkbox"/> 124. Petunias, doubles, grandiflora, 5 blooms, over 2- 1/2" |
| <input type="checkbox"/> 4. | <input type="checkbox"/> 104. Celosia, plumed or crested (cockscomb), 1 bloom | <input type="checkbox"/> 25. | <input type="checkbox"/> 125. Petunias, doubles, multiflora, 5 blooms, 2-1/2" across or less |
| <input type="checkbox"/> 5. | <input type="checkbox"/> 105. Cleome, 3-5 stems (Spider Flower) | <input type="checkbox"/> 26. | <input type="checkbox"/> 126. Petunias, Fantasy, miniature, 5 blooms, less than 1 1/2" |
| <input type="checkbox"/> 6. | <input type="checkbox"/> 106. Cosmos, 3-5 stems | <input type="checkbox"/> 27. | <input type="checkbox"/> 127. Phlox (annual), 3-5 stems |
| <input type="checkbox"/> 7. | <input type="checkbox"/> 107. Dahlia, dinner plate, over 8", 1 bloom | <input type="checkbox"/> 28. | <input type="checkbox"/> 128. Salvia, 3 spikes |
| <input type="checkbox"/> 8. | <input type="checkbox"/> 108. Dahlia, large, 3 blooms, 3" to 8" | <input type="checkbox"/> 29. | <input type="checkbox"/> 129. Snapdragons, 3-5 stems, miniature, less than 8" |
| <input type="checkbox"/> 9. | <input type="checkbox"/> 109. Dahlia, miniatures, 5 blooms, under 3" | <input type="checkbox"/> 30. | <input type="checkbox"/> 130. Snapdragons, 3-5 stems, large, 8" or more |
| <input type="checkbox"/> 10. | <input type="checkbox"/> 110. Daisy, 5-7 blooms | <input type="checkbox"/> 31. | <input type="checkbox"/> 131. Statice, 3-5 stems |
| <input type="checkbox"/> 11. | <input type="checkbox"/> 111. Daisy, Gloriosa, or Rudbeckia and any other daisy single and / or doubles (3-5 stems) | <input type="checkbox"/> 32. | <input type="checkbox"/> 132. Sunflower, 3-5 stems |
| <input type="checkbox"/> 12. | <input type="checkbox"/> 112. Dianthus - type blooms, 5-7 stems | <input type="checkbox"/> 33. | <input type="checkbox"/> 133. Sweet Peas, 10-12 stems |
| <input type="checkbox"/> 13. | <input type="checkbox"/> 113. Geranium, 5-7 stems | <input type="checkbox"/> 34. | <input type="checkbox"/> 134. Verbenas, 5-7 stems |
| <input type="checkbox"/> 14. | <input type="checkbox"/> 114. Gladiolus, large, 3 spikes | <input type="checkbox"/> 35. | <input type="checkbox"/> 135. Zinnias, (large), 5-7 blooms |
| <input type="checkbox"/> 15. | <input type="checkbox"/> 115. Impatiens, 3-5 stems | <input type="checkbox"/> 36. | <input type="checkbox"/> 136. Zinnias, (small), 8-10 blooms, under 2" |
| <input type="checkbox"/> 16. | <input type="checkbox"/> 116. Marigolds, large, 3-5 blooms, more than 2" | <input type="checkbox"/> 37. | <input type="checkbox"/> 137. Any Other Annual (name & variety) |
| <input type="checkbox"/> 17. | <input type="checkbox"/> 117. Marigolds, small, 5-7 blooms, less than 2" | | Category will be added if there are more than five entries of the same species. May enter 3 different varieties of flowers. (Please label) |
| <input type="checkbox"/> 18. | <input type="checkbox"/> 118. Marigolds, singles, 5-7 blooms | | |
| <input type="checkbox"/> 19. | <input type="checkbox"/> 119. Nicotiana, 3-5 stems | | |
| <input type="checkbox"/> 20. | <input type="checkbox"/> 120. Ornamental grass cut (3-7 stems) | | |
| <input type="checkbox"/> 21. | <input type="checkbox"/> 121. Pansies or violas, 5-7 blooms | | |

Division B - Perennials/Biennials
Premiums: \$14.50 • \$13.50 • \$12.50

- | 1st Show Class | 2nd Show Class | 1st Show Class | 2nd Show Class |
|------------------------------|---|------------------------------|--|
| <input type="checkbox"/> 38. | <input type="checkbox"/> 138. Carnations, 3-5 stems | <input type="checkbox"/> 52. | <input type="checkbox"/> 152. Roses, Floribunda, 3-5 stems (multiple large flowers on stems) |
| <input type="checkbox"/> 39. | <input type="checkbox"/> 139. Daisy, Shasta, 3-5 blooms | <input type="checkbox"/> 53. | <input type="checkbox"/> 153. Roses, Miniature, 3-5 stems |
| <input type="checkbox"/> 40. | <input type="checkbox"/> 140. Daisy, (Any other Daisy), 3-5 blooms | <input type="checkbox"/> 54. | <input type="checkbox"/> 154. Roses, Tea Rose, 3 blooms |
| <input type="checkbox"/> 41. | <input type="checkbox"/> 141. Delphinium, large, 3 spikes, 3 ft. and higher | <input type="checkbox"/> 55. | <input type="checkbox"/> 155. Roses, Shrub, 3-5 stems |
| <input type="checkbox"/> 42. | <input type="checkbox"/> 142. Delphinium, small 3 spikes, up to 3 ft. | <input type="checkbox"/> 56. | <input type="checkbox"/> 156. Statice, German, 3-5 stems |
| <input type="checkbox"/> 43. | <input type="checkbox"/> 143. Gaillardia, singles or doubles, 3-5 blooms | <input type="checkbox"/> 57. | <input type="checkbox"/> 157. Yarrow, 5-7 stems |
| <input type="checkbox"/> 44. | <input type="checkbox"/> 144. Liatris or Shooting Star, 3 spikes | <input type="checkbox"/> 58. | <input type="checkbox"/> 158. Any Other Perennials/Biennials (name & variety), 1-3 stems, 12" tall or less Category will be added if there are more than five entries of the same species. May enter 3 different varieties of flowers. |
| <input type="checkbox"/> 45. | <input type="checkbox"/> 145. Lilies, Day, 3-5 stems | | |
| <input type="checkbox"/> 46. | <input type="checkbox"/> 146. Lilies, Asiatic type, 3-5 stems (remove pollen by hand) | | |
| <input type="checkbox"/> 47. | <input type="checkbox"/> 147. Lilies, Oriental type, 3-5 stems (remove pollen by hand) | | |
| <input type="checkbox"/> 48. | <input type="checkbox"/> 148. Lilies, any other type, 3-5 stems (remove pollen by hand) | <input type="checkbox"/> 59. | <input type="checkbox"/> 159. Any Other Perennials/Biennials (name & variety) 1-3 stems, greater than 12" tall. May enter 3 different varieties of flowers. |
| <input type="checkbox"/> 49. | <input type="checkbox"/> 149. Mums, 3-5 sprays | | |
| <input type="checkbox"/> 50. | <input type="checkbox"/> 150. Phlox, 3-5 stems | | |
| <input type="checkbox"/> 51. | <input type="checkbox"/> 151. Ornamental Grass Cut (3-7 stems) | | |

Division C - Artistic Arrangements

Premiums: \$14.50 • \$13.50 • \$12.50

- | 1st Show Class | 2nd Show Class |
|------------------------------|---|
| <input type="checkbox"/> 60. | <input type="checkbox"/> 160. All Greens and/or Green arrangement |
| <input type="checkbox"/> 61. | <input type="checkbox"/> 161. "Autumn Harvest" (using grain and fresh flowers) |
| <input type="checkbox"/> 62. | <input type="checkbox"/> 162. Bouquet of Fragrant Flowers |
| <input type="checkbox"/> 63. | <input type="checkbox"/> 163. Buffet Arrangement |
| <input type="checkbox"/> 64. | <input type="checkbox"/> 164. Dinner Centerpiece, large |
| <input type="checkbox"/> 65. | <input type="checkbox"/> 165. Dinner Centerpiece, small |
| <input type="checkbox"/> 66. | <input type="checkbox"/> 166. Floating Flowers |
| <input type="checkbox"/> 67. | <input type="checkbox"/> 167. "Garden Flowers in a Basket" |
| <input type="checkbox"/> 68. | <input type="checkbox"/> 168. Garden Harvest (using flowers and garden vegetables) |
| <input type="checkbox"/> 69. | <input type="checkbox"/> 169. Miniature Arrangement, less than 5" x 5" |
| <input type="checkbox"/> 70. | <input type="checkbox"/> 170. Mixed Bouquet Arrangement |
| <input type="checkbox"/> 71. | <input type="checkbox"/> 171. Mixed Bouquet Bud Vase |
| <input type="checkbox"/> 72. | <input type="checkbox"/> 172. Monochromatic (shades of one color) |
| <input type="checkbox"/> 73. | <input type="checkbox"/> 173. "North Dakota" (wild flowers and grasses) |
| <input type="checkbox"/> 74. | <input type="checkbox"/> 174. Rose Bud Vase, one bloom with greens and/or fills |
| <input type="checkbox"/> 75. | <input type="checkbox"/> 175. Single Stem with greens and/or fills |
| <input type="checkbox"/> 76. | <input type="checkbox"/> 176. "The Desert Song" (all dried arrangement) |
| <input type="checkbox"/> 77. | <input type="checkbox"/> 177. Tuberous Begonia, 1 stem |
| <input type="checkbox"/> 78. | <input type="checkbox"/> 178. Theme of the Display, "Up, Up, & Away"
(your own creation) |
| <input type="checkbox"/> 79. | <input type="checkbox"/> 179. Bouquet for Church Altar |



Best of Division:

One Best of Division Rosette will be awarded in each division of this department as deemed appropriate by the judge.

Division D - Potted Plants

Premiums: \$14.50 • \$13.50 • \$12.50

- | 1st Show Class | 2nd Show Class |
|-------------------------------|---|
| <input type="checkbox"/> 80. | <input type="checkbox"/> 180. African Violets |
| <input type="checkbox"/> 81. | <input type="checkbox"/> 181. Aloe Vera |
| <input type="checkbox"/> 82. | <input type="checkbox"/> 182. Begonia |
| <input type="checkbox"/> 83. | <input type="checkbox"/> 183. Succulents |
| <input type="checkbox"/> 84. | <input type="checkbox"/> 184. Cactus, Flowering and Non-Flowering |
| <input type="checkbox"/> 85. | <input type="checkbox"/> 185. Coleus |
| <input type="checkbox"/> 86. | <input type="checkbox"/> 186. Dish or Bowl Garden, less than 6" deep |
| <input type="checkbox"/> 87. | <input type="checkbox"/> 187. Fairy Garden |
| <input type="checkbox"/> 88. | <input type="checkbox"/> 188. Fern |
| <input type="checkbox"/> 89. | <input type="checkbox"/> 189. Foliage, Potted |
| <input type="checkbox"/> 90. | <input type="checkbox"/> 190. Foliage, Hanging Basket |
| <input type="checkbox"/> 91. | <input type="checkbox"/> 191. Fuschia, Flowering |
| <input type="checkbox"/> 92. | <input type="checkbox"/> 192. Geranium, Flowering |
| <input type="checkbox"/> 93. | <input type="checkbox"/> 193. Indoor, Flowering |
| <input type="checkbox"/> 94. | <input type="checkbox"/> 194. Ivy Plant |
| <input type="checkbox"/> 95. | <input type="checkbox"/> 195. Million Bells (Callibrachoa) |
| <input type="checkbox"/> 96. | <input type="checkbox"/> 196. Outdoor Hanging, Flowering |
| <input type="checkbox"/> 97. | <input type="checkbox"/> 197. Outdoor Planter (less than 10" pot) |
| <input type="checkbox"/> 98. | <input type="checkbox"/> 198. Outdoor Planter (10" to 14" pot) |
| <input type="checkbox"/> 99. | <input type="checkbox"/> 199. Outdoor Planter, greater than 14" |
| <input type="checkbox"/> 100. | <input type="checkbox"/> 200. Petunias Potted (just petunias) |
| <input type="checkbox"/> 101. | <input type="checkbox"/> 201. Herb Garden (any size) with or without flowers |
| <input type="checkbox"/> 102. | <input type="checkbox"/> 202. Specimen, other than mentioned (name & variety) |

Category will be added if there are more than five entries of the same species. May enter 3 different potted plants. (Please label).



Best of Show:

Best of Show Award will be awarded to one exhibit in this department as deemed appropriate by the judge.

Department 111 - Fine Arts & Crafts

Superintendent: Taube Museum of Art

Fine Arts & Crafts Schedule

	<u>Drop Off</u>	<u>Judging</u>	<u>Pickup</u>
All Fine Arts & Crafts Exhibits	Friday - 7/12 - 10 am-5 pm	Tuesday - 7/16	Saturday - 7/27 - 6-8 pm
	Monday - 7/15 - 10 am-5 pm		Sunday - 7/28 - 10 am-2 pm

Deadline for entry form is July 6, 2024. Open Class Fine Arts & Crafts may be brought to 4-H Hall in the ND State Fair Center.

ENTRY FEE:

- Division A and Division B: \$3.00 / artist
- Division C – L: No entry fee

RULES ON ENTERING:

- Entries must be listed on an official entry form by July 6. Due to our computer entry program, we encourage you to mail your entry form in early. There is also an online entry option that can be found on ndstatefair.com.
- Please clearly print name, address, department, division, and class on the entry form, as well as on the sample being exhibited. Exhibits cannot be accepted unless an entry blank is properly filled out and on file with the Fair Office prior to the closing date for entries.
- Only North Dakota resident artists may enter the Adult Divisions. Only artists' ages 10-16 years of age may enter the Junior Divisions. Those under ten years of age may enter the Children's Divisions.
- All work must have been completed in the past two years and must not have been shown previously at the North Dakota State Fair.
- No entry may be larger than four feet in any dimension including frame, except under textiles where the length may not exceed six feet.
- Entry fee (where required) and entry blank stating the exhibits you plan to show must be in the ND State Fair office by 5pm, July 6. Use separate entry blanks for each department (i.e. flowers, needlework, etc.).
- Please label each entry with division and class number, as well as exhibitor's name and contact information.
- All reasonable care will be given to exhibits entered. The North Dakota State Fair and the Taube Museum of Art will not be responsible for any loss or damage during transit, judging or exhibition.
- All entries must have names and addresses attached to the back lower left-hand corner, unless otherwise specified.
- You may photocopy the entry blank in this booklet, or additional entry blanks may be obtained from the ND State Fair office at the Fairgrounds, P.O. Box 1796, Minot, ND 58702. You may also download additional entry forms at www.ndstatefair.com.
- All reasonable care will be given to exhibits entered. The North Dakota State Fair and its staff will not be responsible for any loss or damage during transit, judging or exhibition. Submission of entry implies acceptance of and compliance with these conditions and regulations. Unless exhibits comply with these rules, they will not be accepted.

RULES ON DROPPING OFF:

- Any article, having been properly entered, can be forwarded by mail or prepaid express to Dept. 111, ND State Fair, PO Box 1796, Minot, ND 58702. The ND State Fair will place the goods on exhibition. The management however, will not be responsible for any breakage of glass or loss of any article. A self-addressed label and return postage must accompany the exhibit for return. The ND State Fair will assume no responsibility for return of exhibit with insufficient postage. Send complete list of articles contained in package. Mailed exhibits must reach the Fair Office by 5 p.m. Thursday, July 11. Entries mailed must be shipped with substantial packing in boxes strong enough for return shipment.

JUDGING CRITERIA:

- An acceptance committee will review all entries for compliance with the rules. Only those entries meeting the rules, as written here, will be judged and displayed. If too many entries are received for the allotted display area, the acceptance committee will choose entries to be displayed. All entries that meet the rules, as written here, will be judged. All prize-winning entries will be displayed. Only original works of art will be eligible.
- Judges need not make awards in any category where competition is lacking.

RULES ON PICKING UP:

- Exhibits will not be released before 6pm on the last day. Exhibits may be picked up on Saturday, July 27 between the hours of 6pm and 8pm, or on Sunday, July 28, between the hours of 10am and 2pm. Ticket stubs must be shown before release. Those picking up exhibits on Saturday, July 27 must pay gate admission.

SPECIAL RULES:

- Oils must be framed, dry and ready to hang. Use ONLY screw eyes and wire
- Watercolors, prints, and drawings must be matted, backed with cardboard or foam core, covered with acetate or shrink wrap and ready for hanging. It is not recommended that glass be used, is at owner's risk. Pieces must have proper and sturdy hanging system. (Ex. Attach wire to back tabs. Use strapping tape to secure tabs.)
- Sculptures of excessively fragile type or enormous size will not be accepted.
- Ceramics, pottery, mosaics: no plaster objects will be accepted.
- Only original works are eligible (no commercial molds or designs).
- Textiles: No kits will be accepted. Hand-woven or loomed, original batik, block printed and/or hand decorated will be accepted. Each item must be labeled for identification. Art-tex or Tri-Chem will not be accepted.
- Crafts - no plastic model kits will be accepted.

Professional: refers to those whose work is produced primarily for the purpose of selling; or who have a diploma, certificate, degree or three or more years of art school training; or teach in their art media.

Amateur: refers to those who do not derive income directly from art. The amateur generally does his art for the pleasure involved and has had little or no art training.

People's Choice: There will be a box for folks to vote for their favorite Fine Art entry in classes A-C. The announcement of the "People's Choice" will be Saturday afternoon. Ten dollars cash prize will be awarded to the winning entry.

Best of Division: One Best of Division Rosette will be awarded in each division of this department. (See each division for amount of award.)

Best of Show: Only (1) Best of Show Award will be given in Fine Arts and Crafts Department. This will be designated by a Purple Rosette Ribbon and a \$35.00 Award

Cash awards will be mailed September 2024.

ADULT DIVISIONS - FINE ARTS

DIVISION A - ORIGINAL WORK

- **Entry fee \$3.00 per artist.** No person may enter more than one article under the same class number.
- All work exhibited must not have been exhibited previously at the North Dakota State Fair.
- All work entered under Original Work cannot be a kit or replica, etc., of someone else's work or work done in an instructional setting.

Best of Division Award: Rosette and \$23.00 cash
Premiums: \$37.00 • \$27.00 • \$18.00 • HM – Ribbon

CLASS

1. Paintings: Traditional or representational. Includes oils, acrylics, transparent and opaque water colors, done with a brush or painting knife.
2. Paintings: Non-representational. Includes same media as Class 1.
3. Portraits: Include any media or same media as Class 1.
4. Paintings: North Dakota subjects or scene. Includes same media as Class 1.
5. Drawings: pencil, ink, pastels (anything done with a drawing medium)
6. Prints: etching, silk screen, linoleum, wood block (any printmaking medium).
7. China Painting: Includes freehand; no stencils or patterns.



DIVISION B - ORIGINAL WORK

- **Entry fee \$3.00 per artist.** No person may enter more than one article under the same class number.
- All work exhibited must not have been exhibited previously at the North Dakota State Fair.
- All work entered under Original Work cannot be a kit or replica, etc., of someone else's work or work done in an instructional setting.

Best of Division Award: Rosette and \$23.00 cash
Premiums: \$37.00 • \$27.00 • \$18.00 • HM – Ribbon

CLASS

1. Sculpture: Any media (includes assemblage and collage)
2. Pottery, Mosaics: Includes clay or earthenware. No molds or kits allowed.
3. Textiles: Hand-weaving, macramé, batik, creative, stitchery, beading. Length limited to 6 ft.
4. Ethnic or Heritage Painting: Any media.
5. Computer Art

DIVISION C - AMATEUR CLASS

- Open to amateurs who do not teach or sell their works.
- No entry fee.
- No person may enter more than one article under the same class number.
- All work exhibited must not have been exhibited previously at the North Dakota State Fair.

Best of Division Award: Rosette and \$14.50 cash
Premiums: \$14.50 • \$13.50 • \$12.50 • HM – Ribbon

CLASS

1. Paintings: Traditional or representational, includes oils, acrylics, transparent & opaque water colors, done with a brush or painting knife.
2. Paintings: Abstract or non-objective or non-representational, Includes same media as Class 1.
3. Portraits: Include any media or same media as Class 1.
4. Paintings: North Dakota subjects or scene. Same media as Class 1.
5. Drawings: pencil, ink, pastels (anything done with a drawing medium)
6. Prints: etching, silk screen, linoleum, wood block (any printmaking medium).
7. Scratch Board
8. Mixed Media

DIVISION D - WOODWORKS

- No entry fee.
- No person may enter more than one article under the same class number except as collections or displays.
- All work exhibited must not have been exhibited previously at the North Dakota State Fair.

Best of Division Award: Rosette and \$14.50 cash
Premiums: \$15.50 • \$14.50 • \$13.00 • HM – Ribbon

CLASS

1. Wood Carving/Sculpture
2. Wood Turning
3. Wood Construction
4. Wood Toys
5. Any other
6. Theme Class - (See Static Information on Page 48)

DIVISION E - TAXIDERMY

- No entry fee.
- No person may enter more than one article under the same class number except as collections or displays.
- All work exhibited must not have been exhibited previously at the North Dakota State Fair.

Best of Division Award: Rosette and \$14.50 cash
Premiums: \$18.00 • \$16.00 • \$14.50 • HM – Ribbon

CLASS

- | | |
|-----------------|-------------------------------------|
| 1. Bird – Large | 6. Large Animal |
| 2. Bird – Small | 7. Game Heads |
| 3. Fish – Large | 8. Any Other |
| 4. Fish – Small | 9. Theme Class - |
| 5. Small Animal | (See Static Information on Page 48) |

DIVISION F - BARN QUILTS

A barn quilt is a basic quilt pattern painted on a piece of wood, large enough and bright enough to be seen from a distance. They are often inspired by fabric quilt patterns and are generally one block of the pattern.

- Entries cannot exceed 3' X 3', but must be a minimum of 16" X 20"
- Exhibitor may enter one item per class
- No entry fee.

Premiums: \$25.00 • \$20.00 • \$15.00

CLASS

1. Barn Quilt on wood
2. Barn Quilt on canvas
3. Theme Class - (See Static Information on Page 48)

DIVISION G - COLLECTIBLE DOLLS/ DOLL RELATED

- No entry fee.
- Each person limited to one entry per class

Best of Division Award: Rosette and \$14.50 cash
Premiums: \$14.50 • \$13.50 • \$12.50

Collectible Dolls

CLASS

- | | |
|-----------------------------|-------------------------------------|
| 1. Antique - Pre 1940 | 5. Miniature – 8" or smaller |
| 2. Old – 1940 to 1970 | 6. Handcrafted – Any |
| 3. Modern – 1971 to Present | 7. Theme Class - |
| 4. Ethnic - Any | (See Static Information on Page 48) |

DIVISION H - ADULT CRAFTS

- No entry fee.
- No person may enter more than one article under the same class number.
- All work exhibited must not have been exhibited previously at the North Dakota State Fair.

Best of Division Award: Rosette and \$14.50 cash
Premiums: \$14.50 • \$13.50 • \$12.50 • HM – Ribbon

CLASS

1. Homemade/Crafted Dolls
2. Ceramics (form molds) - Glazed
3. Ceramics - Chalks
4. Ceramics - Dry Brushing
5. Ceramics - Any Other
6. Ethnic Crafts
7. Artificial Flowers/Dried Flowers
8. Carved or Tooled Leather
9. Centerpieces
10. Buttons (Anything done with buttons)
11. Recycled or Original Craft Items
12. Stain Glass/Glass Etching/Gallery Glass/Mosaic Glass
13. Stationary/Card Design/Calligraphy
14. Wall Hangings
15. Stitchery
16. Wood Crafts/Wood Toys
17. Soft Sculpture (not dolls)
18. Holiday Crafts
19. Jewelry
20. Basketry
21. Paper Sculpture/Paper Making/Paper Mache
22. Models (architecture, other objects) - no kits
23. Diamond Dots- size limit 11x14
24. Decorated Graduation Caps
25. Theme Class - (See Static Information on Page 48)

FINE ART - JUNIOR DIVISIONS

This division is open to anyone ages 10 to 16 years.
Please state age on entry blank.

DIVISION I - JUNIOR ART

- No entry fee.
- Each artist limited to four entries in this division, but only one entry per class.
- Be sure and follow special rule #2 concerning mounting.

Best of Division Award: Rosette and \$14.50 cash
Premiums: \$25.00 • \$20.00 • \$15.00 • HM – Ribbon

CLASS

1. Painting - all brush media
2. Prints - etching, silk screen, linoleum, wood block (any printmaking medium)
3. Drawings - lead or graphite pencils, black ink, charcoal
4. Drawings - colored (pencil, markers, pastels, ink)
5. Pottery, Mosaics (clay, earthenware) - No molds
6. Computer Art
7. Scratch Board
8. Mixed Media
9. Theme Class - (See Static Information on Page 48)

DIVISION J - JUNIOR CRAFTS

- No entry fee.
- No person may enter more than one article under the same class number.

Best of Division Award: Rosette and \$14.50 cash
Premiums: \$20.00 • \$18.00 • \$15.00 • HM – Ribbon

CLASS

1. Leather Work
2. Wood Construction
3. Ceramics - from molds
4. Plaques
5. Creative Stitchery
6. Kits/Puzzles/Legos
7. Jewelry
8. Holiday Crafts
9. Hand-crafted Dolls
10. Soft Sculpture (not dolls)
11. Paper Sculpture/Paper Making/Paper Mache
12. Models (architecture, other objects) - No kits
13. Centerpieces
14. Artificial Flowers/Dried Flowers
15. Buttons (anything done with buttons)
16. Recycled or Original Craft Items
17. Diamond Dots- size limit 8x10
18. Theme Class - (See Static Information on Page 48)

FINE ART - CHILDREN'S DIVISION

*This division is open to anyone age 9 and under.
Please state age on entry blank.*

DIVISION K - CHILD'S ART

- No entry fee.
- Each artist limited to four entries in this division, but only one entry per class.
- Be sure and follow special rule #2 concerning mounting.

Best of Division Award: Rosette and \$14.50 cash
Premiums: \$25.00 • \$18.00 • \$15.00 • HM – Ribbon

CLASS

1. Painting - All brush media
2. Prints - Etching, silk screen, linoleum, wood block (any printmaking medium)
3. Drawings - Lead or graphite pencil, black ink
4. Drawings - Colored (pencil, markers, pastels, ink)
5. Pottery, Mosaics - (clay, earthenware) - No molds or kits
6. Computer Art
7. Scratch Board
8. Mixed Media
9. Theme Class - (See Static Information on Page 48)



DIVISION L - CHILD'S CRAFT

- No entry fee.
- No person may enter more than one article under the same class number.

Best of Division Award: Rosette and \$12.50 cash
Premiums: \$18.00 • \$16.00 • \$14.00 • HM – Ribbon

CLASS

1. Wood Construction
2. Ceramics - from molds
3. Plaques
4. Hand-crafted Doll
5. Creative Stitchery
6. Holiday Crafts
7. Jewelry
8. Soft Sculpture (not dolls)
9. Kits/Puzzles/Legos
10. Paper Sculpture/Paper Making/Paper Mache
11. Models (architecture, other objects) - No kits
12. Centerpieces
13. Artificial Flowers / Dried Flowers
14. Buttons (anything done with buttons)
15. Recycled or Original Craft Items
16. Diamond Dots- size limit 8x10
17. Theme Class - (See Static Information on Page 48)

FINE ART - CHILDREN'S DIVISION

*This division is open to anyone age 65 and over.
Please state age on entry blank.*

DIVISION M - SENIOR CITIZEN ARTS & CRAFTS

- No entry fee.
- No person may enter more than one article under the same class number.

Best of Division Award: Rosette and a \$15.00 award.
Premiums: \$14.50 • \$13.50 • \$12.50 • HM – Ribbon

CLASS

1. Painting - All brush media
2. Prints - etching, silk screen, linoleum, wood block (any print making medium)
3. Drawings - black and white or colored pencil, ink, markers, pastels (any drawing medium)
4. Diamond Dots- size limit 11x14
5. Sculpture - Any media (includes assemblage and collage)
6. Pottery, Mosaics - (clay, earthenware) - No molds or kits
7. Wood Crafts/Wood toys
8. Ceramics - From molds - Glazes
9. Ceramics - From molds - Stains
10. Ceramics - Any other
11. Plastic Canvas
12. Stitchery, Macramé
13. Soft Sculpture (includes hand crafted dolls)
14. Holiday Crafts
15. Jewelry
16. Wall Hangings
17. China Painting - free hand, no stencils or patterns
18. Theme Class - (See Static Information on Page 48)

Department 112 - Food

Superintendents: Sharon Schwarz & Carol Kraft

<i>Food Schedule</i>			
	<u>Drop Off</u>	<u>Judging</u>	<u>Pickup</u>
All Food Exhibits	Wednesday - 7/17 - 10 am-5 pm	Thursday - 7/18	Saturday - 7/27 - 6-8 pm
	Thursday - 7/18 - 8-11 am		Sunday - 7/28 - 10 am-2 pm

Deadline for entry form is July 6, 2024. Open Class Foods may be brought to 4-H Hall in the ND State Fair Center.

ENTRY FEE: None

RULES ON ENTERING:

- Entries must be listed on an official entry form by July 6. Due to our computer entry program, we encourage you to mail your entry form in early. There is also an online entry option that can be found on ndstatefair.com.
- Please clearly print name, address, department, division, and class on the entry form, as well as on the sample being exhibited. Exhibits cannot be accepted unless an entry blank is properly filled out and on file with the Fair Office prior to the closing date for entries.
- Use separate entry blanks for each department (i.e. flowers, needlework, etc.).
- Competition is open to North Dakota residents only.
- No person can enter more than one item under the same class number in any department. The “any other” class is for items not listed. All reasonable care will be given to exhibits entered. The North Dakota State Fair and its staff will not be responsible for any loss or damage during transit, judging or exhibition. Submission of entry implies acceptance of and compliance with these conditions and regulations.
- Unless exhibits comply with these rules, they will not be accepted.

RULES ON DROPPING OFF:

- Any article, having been properly entered, can be forwarded by mail or prepaid express to Dept. 112, ND State Fair, PO Box 1796, Minot, ND 58702, where it will then be placed on exhibition. The management however, will not be responsible for any breakage of glass or loss of any article. A self-addressed label and return postage must accompany the exhibit for return. The ND State Fair will assume no responsibility for return of exhibit with insufficient postage. Send complete list of articles contained in package. Mailed exhibits must reach the Fair Office no later than noon **Wednesday, July 17.**
- No entries will be accepted after deadline. Judging will begin Thursday, July 18 at 12:30pm.
- All baked goods must be removed from pans before exhibited, except pies which should be in disposable pans.
- Exhibits must be entered on disposable plates and wrapped in plastic.

JUDGING CRITERIA:

- The judges are instructed not to award prizes unless the articles are deemed of real merit, even though they may be the only entry in the class.

RULES ON PICKING UP:

- Exhibits will not be released before 6pm on the last day. Exhibits may be picked up on Saturday, July 27 between the hours of 6pm and 8pm or on Sunday, July 28 between the hours of 10am and 2pm. Claim checks must be shown before release. The building will be closed at 8pm Saturday, July 27. Those picking up exhibits Saturday must pay gate admission.

Best of Division:

One Best of Division Rosette will be awarded in each division of this department as deemed appropriate by the judge.

Best of Show:

Best of Show Award will be awarded to one exhibit in this department as deemed appropriate by the judge.

Cash awards will be mailed September 2024

NORTH DAKOTA MILL & ELEVATOR

will offer the following special prizes for the following culinary classes:

Division A: Class 4 - White Bread, Class 7 - Rolls
Division E: Class 4 - Filled Cookies

1st Place - 50 lbs. Dakota Maid Flour
2nd Place - 25 lbs. Dakota Maid Flour
3rd Place - 10 lbs. Dakota Maid Flour



The North Dakota Wheat Commission

The North Dakota Wheat Commission promotes the use of high quality wheat and offer the following prizes to the first place winners in each class

Division A
Classes 1-17: \$15.00



CULINARY DIVISIONS A-G

DIVISION A - YEAST BREADS

May enter large or small loaf, one unless otherwise listed.

Premiums: \$14.50 • \$13.50 • \$12.50

CLASS

1. Bread, multi-grain, (please include recipe)
2. Bread, fruit
3. Bread, rye
4. Bread, white
5. Bread, whole wheat (please include recipe)
6. Bread, made in electric breadmaker
7. Rolls, dinner, 4
8. Rolls, cinnamon, 4
9. Rolls, cinnamon, frosted, 4
10. Rolls, fancy, frosted 4
11. Rolls, crescent, 4
12. Rolls, caramel, 4
13. Breakfast Loaf, 1
14. Buns, white, 4
15. Buns, whole wheat, 4 (please include recipe)
16. Artisan
17. Any other (please label)
18. Theme Class - (See Static Information on Page 48)

DIVISION B - QUICK BREADS

May enter large or small loaf, one unless otherwise listed.

Premiums: \$13.50 • \$12.50 • \$11.50

CLASS

1. Baking Powder Biscuits, 4
2. Banana Bread
3. Date Bread
4. Zucchini Bread
5. Pumpkin Bread
6. Muffins, 4
7. Gingerbread
8. Any other (please label)
9. Theme Class - (See Static Information on Page 48)

DIVISION C - CAKES

Commercial mixes ONLY accepted in category 11

Premiums: \$13.50 • \$12.50 • \$11.50

CLASS

1. Angelcake, not frosted
2. Chocolate Layer or Loaf Cake, any frosting
3. Fruit Cake, light or dark, not frosted
4. Sponge Cake, not frosted
5. White Layer or Loaf Cake, any frosting
6. Jelly Roll
7. Bundt Cake
8. Decorations (decorations only judged) Layer or Sheet cake
9. Decorations (decorations only judged) Novelty Cakes
10. Cupcakes
11. Cake Mixes
12. Any other (please label)
13. Theme Class - (See Static Information on Page 48)

DIVISION D - PIES

Please Use large or small disposable pans

Premiums: \$14.50 • \$13.50 • \$12.50

CLASS

1. Apple Pie
2. Cherry Pie
3. Rhubarb Pie
4. Any Berry Pie
5. Any Other Fruit Pie
6. Cream Pie
7. Lemon Pie
8. Any other (please label)
9. Theme Class - (See Static Information on Page 48)

DIVISION E - COOKIES

Premiums: \$13.50 • \$12.50 • \$11.50

CLASS

1. Butter Cookies, Plain, 4
2. Butter Cookies, Fancy, 4
3. Chocolate Drop Cookies, 4
4. Filled Cookies, 4
5. Ginger Cookies, frosted, 4
6. Molasses Cookies, 4
7. Ice Box Cookies, 4
8. Macaroons, 4
9. Oatmeal Cookies, 4
10. White Cookies, rolled, 4
11. Chocolate Chip Cookies, 4
12. Unbaked Cookies, 4
13. Peanut Butter Cookies, 4
14. Sugar Cookies, 4
15. Special Party Cookies, 4
16. Monster Cookies, 4
17. Cake Mix Cookies, 4
18. Bars, Frosted, 4
19. Bars, Unfrosted, 4
20. Bars, Rice Krispies, 4
21. Bars, Lemon, 4
22. Bars, Unbaked, 4
23. Cookies, Any Other, 4 (please label)
24. Theme Class - (See Static Information on Page 48)

DIVISION F - CANDY

Premiums: \$13.50 • \$12.50 • \$11.50

CLASS

1. Dip Candy, 6 pieces
2. Divinity, 6 pieces
3. Peanut Brittle, 6 pieces
4. Fudge, 6 pieces
5. Caramels, 6 pieces
6. Pinoche, 6 pieces
7. Plate of Assorted Candies, 4 kinds, 8 pieces total
8. Any other, 6 pieces (please label)
9. Theme Class - (See Static Information on Page 48)

DIVISION G - FRIED/ETHNIC

Premiums: \$13.50 • \$12.50 • \$11.50

CLASS

- | | |
|------------------------|---|
| 1. Raised Doughnuts, 4 | 8. Sandbakkelse, 4 |
| 2. Doughnuts, 4 | 9. Kuchen, 1 Whole |
| 3. Fattigman, 4 | 10. Julekaka Christmas Bread, 1 loaf |
| 4. Flat Bread, 4 | 11. Any other, 4 (please label) |
| 5. Krumkaka, 4 | 12. Theme Class - (See Static Information on Page 48) |
| 6. Lefse, 4 | |
| 7. Rosettes, 4 | |

DIVISION H - SPECIAL DIET

(Sugar-free, lowfat, low cholesterol, salt-free, and gluten-free)

Please label as to which diet and include recipe

Premiums: \$13.50 • \$12.50 • \$11.50

CLASS

- | | |
|-----------------|--|
| 1. Cake | 6. Yeast Breads |
| 2. Candy | 7. Any other |
| 3. Cookies, 4 | 8. Theme Class - (See Static Information on Page 48) |
| 4. Pie | |
| 5. Quick Breads | |

Don't Forget to LABEL!



FOOD PRESERVATION DIVISIONS I-N

Canned foods for exhibit must be in standard canning jars, with standard lids or covers. Use current USDA guidelines for preserving foods. Please label jars with name of product and date of preparation. Please indicate method of preparation: boiling water or pressure canner. Must be canned from crop of 2022 or 2023.

DIVISION I - CANNED FRUITS

(Please label jars)

Premiums: \$14.50 • \$13.50 • \$12.50

CLASS

- | | |
|----------------------|---|
| 1. Apples | 13. Peaches |
| 2. Applesauce | 14. Pears |
| 3. Apricots | 15. Plums |
| 4. Blueberries | 16. Plums, wild |
| 5. Cherries, bing | 17. Raspberries |
| 6. Cherries, compass | 18. Rhubarb |
| 7. Crabapple | 19. Strawberries |
| 8. Currant, red | 20. Fruit Pie Filling, any kind (please label) |
| 9. Fruit Cocktail | 21. Fruit Juice, any kind (please label) |
| 10. Grapes | 22. Any other Wild Fruit (please label) |
| 11. Gooseberries | 23. Theme Class - (See Static Information on Page 48) |
| 12. June Berries | |

DIVISION J - JELLIES & JAMS (SOFT SPREADS)

(Please label jars)

Premiums: \$13.50 • \$12.50 • \$11.50

Jellies and jams should be shown in standard 1/2 or 1 cup sealed jars. Process with boiling water bath. Must be safe without refrigeration. Use a 1/4" head space.

CLASS

- | | |
|--------------------------------|---|
| 1. Jelly, Apple or Crabapple | 18. Jam, Blueberry |
| 2. Jelly, Bing Cherry | 19. Jam, Chokecherry |
| 3. Jelly, Blueberry | 20. Jam, Grape |
| 4. Jelly, Chokecherry | 21. Jam, Plum, wild |
| 5. Jelly, Nanking Cherry | 22. Jam, Raspberry |
| 6. Jelly, Cranberry, high bush | 23. Jam, Rhubarb |
| 7. Jelly, Currant, red | 24. Jam, Strawberry |
| 8. Jelly, Grape | 25. Jam, Strawberry Rhubarb |
| 9. Jelly, Grape, wild | 26. Jam, Tomato |
| 10. Jelly, Gooseberry | 27. Jam, Peach |
| 11. Jelly, Juneberry | 28. Apple Butter |
| 12. Jelly, Plum | 29. Marmalade, Peach and Apricot |
| 13. Jelly, Plum, wild | 30. Marmalade, Rhubarb |
| 14. Jelly, Raspberry, red | 31. Syrups, Fruit |
| 15. Jelly, Rhubarb | 32. Any other (please label) |
| 16. Jelly, Strawberry | 33. Theme Class - (See Static Information on Page 48) |
| 17. Jam, Apricot | |

DIVISION K - DRIED FRUITS & VEGETABLES

Dried sample for display of 1 cup in covered glass container (Please label jars)

Premiums: \$13.50 • \$12.50 • \$11.50

CLASS

- | | |
|------------------|---|
| 1. Apple | 9. Peaches |
| 2. Apricots | 10. Pears |
| 3. Banana | 11. Potatoes |
| 4. Carrots | 12. Snack Mix |
| 5. Celery | 13. Tomatoes |
| 6. Corn | 14. Any other (please label) |
| 7. Fruit Leather | 15. Theme Class - (See Static Information on Page 48) |
| 8. Onions | |

DIVISION L - CANNED VEGETABLE

NOTE: Meat, Poultry & Vegetables (not tomatoes) must be canned by use of a pressure cooker (Please label jars)

Premiums: \$13.50 • \$12.50 • \$11.50

CLASS

- | | |
|-----------------|---|
| 1. Asparagus | 12. Sauerkraut |
| 2. Beans, green | 13. Tomatoes |
| 3. Beans, wax | 14. Tomato Juice |
| 4. Beets | 15. Tomatoes, stewed |
| 5. Carrots | 16. Zucchini |
| 6. Corn | 17. Mixture of vegetables for soup |
| 7. Corn on Cob | 18. Vegetable Juice, any kind (please label) |
| 8. Greens | 19. Any other (please label) |
| 9. Parsnip | 20. Theme Class - (See Static Information on Page 48) |
| 10. Peas | |
| 11. Pumpkin | |

THE NORTH DAKOTA WHEAT COMMISSION

promotes the use of high quality wheat and offered the following prizes to the first place winners in each class
Division O, Junior Department
Classes 1, 2, 7-10: \$25.00



DIVISION M - PICKLES & RELISHES

(Please label jars)

Premiums: \$13.50 • \$12.50 • \$11.50

CLASS

- | | |
|-----------------------------|---|
| 1. Beet Pickles | 16. Zucchini Pickles |
| 2. Green Bean Pickles | 17. Ketchup |
| 3. Carrot Pickles | 18. Barbecue Sauce |
| 4. Crabapple Pickles | 19. Chili Sauce |
| 5. Cucumbers, sweet | 20. Salsa Sauce |
| 6. Dill Pickles | 21. Spaghetti Sauce, without meat |
| 7. Bread and Butter Pickles | 22. Corn Relish |
| 8. Green Tomato Pickles | 23. Cucumber Relish |
| 9. Mixed Pickles | 24. Tomato Relish |
| 10. Mustard Pickles | 25. Zucchini Relish |
| 11. Onion Pickles | 26. Any other not listed (please label) |
| 12. Peach Pickles | 27. Theme Class - (See Static Information on Page 48) |
| 13. Pear Pickles | |
| 14. 10 to 14 Day pickles | |
| 15. Watermelon Pickles | |

DIVISION N - MEATS

All meats must be pressure canned.

(Please label jars)

Premiums: \$13.50 • \$12.50 • \$11.50

CLASS

- | | |
|--------------------|---|
| 1. Beef, canned | 6. Canned Fish |
| 2. Chicken, canned | 7. Wild Game |
| 3. Pork, canned | 8. Jerky |
| 4. Sausage, canned | 9. Any other (please label) |
| 5. Mincemeat | 10. Theme Class - (See Static Information on Page 48) |

Kid's Cupcake Decorating Contest



Saturday, July 27
Upper Atrium



Registration Opens at 12:30
Contest Begins at 1:00

DIVISION O - JUNIOR DEPARTMENT

Ages 10 & under AND Ages 11-17

Please list age on entry form

Premiums: \$18.00 • \$16.00 • \$14.00

CLASS

1. Bread, White, small loaf
 2. Bread, Dark, small loaf
 3. Bread, Banana, small loaf
 4. Bread, Any Other, small loaf
 5. Buns, White, 4
 6. Buns, Wheat, 4
 7. Muffins, 4
 8. Rolls, Cinnamon, 4
 9. Rolls, Fancy - Frosted, 4
 10. Rolls, Caramel, 4
 11. Rolls, Any Other, 4 (Please Label)
 12. Decorations (decorations only judged) Cake
 13. Decorations (decorations only judged) Cupcakes, 4
 14. Decorations (decorations only judged) Special Party Cookies, 4
 15. Cake, Chocolate, One Layer, unfrosted
 16. Cake, White, One Layer
 17. Cookies, Chocolate Chip, 4
 18. Cookies, Chocolate Chip, 4 in a Decorated Container (container and cookies judged)
 19. Cookies, Peanut Butter, 4
 20. Cookies, Unbaked, 4
 21. Cookies, Oatmeal, 4
 22. Cookies, White, 4
 23. Cookies, Ginger, 4
 24. Cookies, Monster, 4
 25. Cookies, Frosted, 4
 26. Cookies, Cake Mix, 4
 27. Cookies, Any Other Kind, 4 (please label)
 28. Unfrosted Brownies, 4
 29. Unbaked Bars, 4
 30. Crispy Rice Bars, 4
 31. Bars, Any Other, 4 (please label)
 32. Doughnuts, 4
 33. Pie
 34. Peanut Brittle, 6 Pieces
 35. Fudge, 6 Pieces
- (Label jars and see Division B instructions)*
36. Jelly, grape
 37. Jelly, chokecherry
 38. Jelly, any other
 39. Jam, strawberry
 40. Jam, rhubarb
 41. Jam, raspberry
 42. Jam, any other
 43. Apple butter
 44. Applesauce
 45. Dill Pickles
 46. Sweet Pickles
 47. Relish, state kind
 48. Vegetables, any kind, canned
 49. Fruit, any kind, canned
 50. Dried Fruit
 51. Fruit Leather
 52. Salsa
 53. Any other canned item
 54. Any other not listed above
 55. Theme Class - (See Static Information on Page 48)

Department 113 - Needlework

Superintendents: Sharon Schwarz & Carol Kraft

Needlework Schedule

	<u>Drop Off</u>	<u>Judging</u>	<u>Pickup</u>
All Needlework Entries	Friday - 7/12 - 10am-5pm	Tuesday - 7/16	Saturday - 7/27 - 6-8pm
	Monday - 7/15 - 10am-5pm		Sunday - 7/28 - 10am-2pm

Deadline for entry form is July 6, 2024. Open Class Needlework may be brought to 4-H Hall in the ND State Fair Center.

ENTRY FEE: None

RULES ON ENTERING:

- Entries must be listed on an official entry form by July 6. Due to our computer entry program, we encourage you to mail your entry form in early. There is also an online entry option that can be found on ndstatefair.com. Fair management is not bound to accept entries made after the deadline.
- Please clearly print name, address, department, division, and class on the entry form, as well as on the sample being exhibited. Exhibits cannot be accepted unless an entry blank is properly filled out and on file with the Fair Office prior to the closing date for entries.
- Use separate entry blanks for each department (i.e. flowers, needlework, etc.).
- Competition is open to North Dakota residents only.
- No person can enter more than one item under the same class number in any department. The “any other” class is for items not listed.
- Please enter exhibit under person’s name who made it
- Needlework items must be constructed using some type of needle and thread or yarn
- All reasonable care will be given to exhibits entered. The North Dakota State Fair and its staff will not be responsible for any loss or damage during transit, judging or exhibition. Submission of entry implies acceptance of and compliance with these conditions and regulations.
- Unless exhibits comply with these rules, they will not be accepted.

RULES ON DROPPING OFF:

- Any article, having been properly entered, can be forwarded by mail or prepaid express to Dept. 113, ND State Fair, PO Box 1796, Minot, ND 58702, where it will then be placed on exhibition. The management however, will not be responsible for any breakage of glass or loss of any article. A self-addressed label and return postage must accompany the exhibit for return. The ND State Fair will assume no responsibility for return of exhibit with insufficient postage. Send complete list of articles contained in package. Mailed exhibits must reach the Fair Office no later than 5pm Thursday, July 11.
- No entries will be accepted after deadline. Judging will begin Tuesday, July 16 at 12:30pm.
- All baked goods must be removed from pans before exhibited, except pies which should be in disposable pans.
- Exhibits must be entered on disposable plates and wrapped in plastic.

JUDGING CRITERIA:

- The judges are instructed not to award prizes unless the articles are deemed of real merit, even though they may be the only entry in the class.
- Any article exhibited in prior years at the North Dakota State Fair is ineligible to show

RULES ON PICKING UP:

- Exhibits will not be released before 6pm on the last day. Exhibits may be picked up on Saturday, July 27 between the hours of 6pm and 8pm or on Sunday, July 28 between the hours of 10am and 2pm. Claim checks must be shown before release. The building will be closed at 8pm Saturday, July 27. Those picking up exhibits Saturday must pay gate admission.

Best of Division:

One Best of Division Rosette will be awarded in each division of this department as deemed appropriate by the judge.

Cash awards will be mailed September 2024

Best of Show:

One Best of Show Award will be given in the Needleworks Department, and as well in Division M: Quilting

DIVISION A - AFGANS/BEDSPREADS

Premiums: \$14.50 • \$13.50 • \$12.50

CLASS

1. Afghan, Crocheted (pieced)
2. Afghan, Crocheted (continuous)
3. Afghan, Knitted
4. Baby Afghans (30" x 48" max), Crocheted (pieced)
5. Baby Afghans (30" x 48" max), Crocheted (continuous)
6. Baby Afghans (30" x 48" max), Knitted
7. Afghan, Any other
8. Child's Bedspread (45" x 60") Sewn or Quilted
9. Bedspread (72" x 90" or larger), Crocheted
10. Bedspread, Any other, Sewn or Quilted
11. Theme Class - (See Static Information on Page 48)

DIVISION B - TABLE COVERINGS

Tablecloths (2 yards & over)
Luncheon cloths (under 2 yards)
Premiums: \$14.50 • \$13.50 • \$12.50

CLASS

1. Tablecloth, Crocheted
2. Tablecloth, Embroidered (Hand)
3. Tablecloth, Embroidered (Machine)
4. Tablecloth, Any other
5. Luncheon, Crocheted
6. Luncheon, Embroidered (Hand)
7. Luncheon, Embroidered (Machine)
8. Luncheon, Any other
9. Theme Class - (See Static Information on Page 48)

DIVISION C - SMALL TABLE COVERINGS

(Oval, Round or Square- 14" to 30")
(Rectangle- any size)
Premiums: \$13.50 • \$12.50 • \$11.50

CLASS

1. Oval, Round or Square, Hardanger
2. Oval, Round or Square, Crocheted
3. Oval, Round or Square, Embroidered- Hand
4. Oval, Round or Square, Embroidered- Machine
5. Oval, Round or Square, Appliqued
6. Oval, Round or Square, Wool
7. Oval, Round or Square, Cloth- Sewn or Quilted
8. Oval, Round or Square, Any other
9. Rectangle Table Runner, Sewn or Quilted
10. Rectangle Table Runner, Wool
11. Rectangle Table Runner, Any other
12. Theme Class - (See Static Information on Page 48)

DIVISION D - DOILES

Oval or Round (Under 14")
Premiums: \$13.50 • \$12.50 • \$11.50

CLASS

1. Doily, Knitted
2. Doily, Crocheted
3. Doily, Embroidered
4. Doily, Hardanger
5. Doily, Any Other
6. Theme Class - (See Static Information on Page 48)

DIVISION E - TOYS

Premiums: \$13.50 • \$12.50 • \$11.50

CLASS

1. Animals, Sewn and Stuffed
2. Animals, Any other
3. Doll, Sewn and Stuffed
4. Doll, Any other
5. Doll, Dressed with Wardrobe (3 outfits)
6. Doll, Dressed (1 Outfit on Doll)
7. Quiet Book
8. Toy, Any other
9. Theme Class - (See Static Information on Page 48)

DIVISION F - CROCHETED WEARING APPAREL

Premiums: \$15.00 • \$14.50 • \$13.50

CLASS

1. Collar or Cowl
2. Neck Scarf
3. Sweater, Adult
4. Sweater, Child
5. Sweater, Infant
6. Bonnet or Cap, Infant
7. Booties, Infant
8. Slippers, Any size
9. Dress, Infant
10. Shawl, Adult, Color work
11. Shawl, Adult, Textured
12. Hat, Adult
13. Hat, Infant
14. Original design/pattern
15. Adult, Any other
16. Child or Infant, Any other
17. Theme Class - (See Static Information on Page 48)

DIVISION G - KNITTED WEARING APPAREL

Premiums: \$15.00 • \$14.50 • \$13.50

CLASS

1. Sweater, plain, adult
2. Sweater, plain, child (over 2 years)
3. Sweater, color work, adult
4. Sweater, color work, child (over 2 years)
5. Sweater, textured, adult
6. Sweater, textured, child (over 2 years)
7. Sweater, machine knitted, adult
8. Sweater, machine knitted, child (over 2 years)
9. Collar or cowl
10. Neck Scarf
11. Outerwear, Adult
12. Outerwear, Child (over 2 years)
13. Vest or Shell, Adult
14. Sweater & cap, Infant
15. Booties, Infant
16. Mittens, Any size
17. Slippers, Any size
18. Stockings, Any size
19. Shawl, Adult, Textured
20. Shawl, Adult, Color work
21. Gloves, Any size
22. Hat, Any Size
23. Original design/pattern
24. Adult, Any other
25. Child, Any other
26. Theme Class - (See Static Information on Page 48)

DIVISION H - CLOTHING, INFANTS (SEWN)

(Under 2 years of age)

Premiums: \$15.00 • \$14.50 • \$13.50

CLASS

1. Bib
2. Outerwear
3. Dress
4. Play Set
5. Sleepwear
6. Receiving Blanket
7. Baptismal Wear
8. Any other
9. Theme Class - (See Static Information on Page 48)

DIVISION I - CLOTHING, CHILDREN (SEWN)

(2 years and older)

Premiums: \$14.50 • \$13.50 • \$12.50

CLASS

1. Coat, lined
2. Jacket
3. Shorts and Top Outfit
4. Dress
5. Special Dress (Communion, etc.)
6. Sweat suit (Knit fabric)
7. Jumper
8. Skirt
9. Shirt or Blouse
10. Sleepwear
11. Vest
12. Apron
13. Costume
14. Made Over Garment
15. Wearable Art
16. Original Design/pattern
17. Any other
18. Theme Class - (See Static Information on Page 48)

DIVISION J - CLOTHING, ADULTS

Premiums: \$15.00 • \$14.50 • \$13.50

CLASS

- | | |
|----------------------------------|---|
| 1. Dress, one piece, any fabric | 14. Nightwear |
| 2. Dress, two pieces, any fabric | 15. Pants or Slacks |
| 3. Suit, lined | 16. Sweatshirt, decorated, any kind |
| 4. Suit, unlined | 17. Wedding Gown |
| 5. Coat or Jacket, lined | 18. Bridesmaid Gown |
| 6. Coat or Jacket, unlined | 19. Costume |
| 7. Blazer, lined | 20. Wearable Art |
| 8. Blazer, unlined | 21. Made Over Garment |
| 9. Cape or shawl | 22. Original Design/pattern |
| 10. Skirt | 23. Any other |
| 11. Blouse or Shirt | 24. Theme Class - (See Static Information on Page 48) |
| 12. Vest | |
| 13. Sporting Outfit, 2 pieces | |

DIVISION K - SENIOR CITIZEN

(65 years and older)

Articles must have been made within the last two years

Premiums: \$15.50 • \$14.50 • \$13.50

CLASS

1. Afghan, crocheted
2. Afghan, knitted
3. Afghan, granny squares
4. Luncheon cloth (under 2 yards)
5. Table cloth (over two yards)
6. Pot Holder, (2) crocheted
7. Pot Holder, (2) knitted
8. Pot Holder, (2) cloth
9. Oval, Round or Square Table Covering, 14" - 30", Crochet or Knit
10. Oval, Round or Square Table Covering, 14" - 30", Cloth, Sewn or Quilted
11. Table Runner, Rectangular, Cloth, Sewn or Quilted
12. Doily, 14" & under, Crochet or Knit
13. Doily, any other
14. Kitchen/Dish Towels, (2) Embroidered, Hand
15. Kitchen/Dish Towels, (2) Embroidered, Machine
16. Kitchen/Dish Towels, (2) Applique
17. Pillow, any kind
18. Pillowcases (one pair, any kind)
19. Gloves or mittens, Crochet or Knit
20. Garment, Crochet or Knit
21. Neck Scarf, Crochet or Knit
22. Collar or Cowl, Crochet or Knit
23. Apron
24. Floor Rug, any type
25. Children's Clothing, sewn
26. Infant Wear, Knit
27. Infant Wear, Crochet
28. Quilt, any size
29. Wall Hanging, any kind or size
30. Purse, any size or kind
31. Tote bag, any size or kind
32. Shawl, knit, crochet or cloth
33. Hardanger, any size
34. Wool item, any size
35. Any other
36. Theme Class - (See Static Information on Page 48)



DIVISION L - YOUTH DEPARTMENT

Children: Ages 10 and Under

Juniors: Ages 11 - 17

(Please list age on entry form)

Premiums: \$18.00 • \$16.00 • \$14.00

CLASS

1. Blouse or shirt
2. Vest
3. Shorts or Pants
4. Dress
5. Nightwear
6. Wearable Art
7. Stuffed Toy or Animal
8. Doll clothes (one outfit)
9. Pillow, any kind or size
10. Pillowcase (1), sewn
11. Tote Bag or Purse
12. Knit Item
13. Crocheted Item
14. Latch Hook Item
15. Counted Cross Stitch Item
16. Plastic Canvas Item
17. Embroidered Item, Hand
18. Embroidered Item, Machine
19. Seasonal or Holiday Item
20. Recycled Item, any kind
21. Any other item or garment
22. Theme Class - (See Static Information on Page 48)



DIVISION M - QUILTING

Sponsored by the Minot Prairie Quilt Guild and the

North Dakota State Fair

Premiums: \$16.00 • \$15.00 • \$14.50

100% of monies sponsored by North Dakota quilt guilds and quilt shops will be added to premiums in this division.

- Quilts including more than one technique should be entered in the category of the predominant technique.
- Quilt must be constructed and quilted by the person entering it, except for the “professionally quilted” and “group” categories.
- All quilts must be constructed and quilted by the person entering them, except for the “commercially quilted” and “group categories.”
- The term “Machine Quilted” indicates that the quilting was done on a home sewing machine or a mid-arm or long-arm machine, by either the person entering the quilt or by someone who is not being paid to do the quilting (not limited to one person).
- “Professionally” quilted indicates that quilting was done by someone who quilts for hire.
- A “quilt” is a fabric sandwich (three layers) held together with hand or machine quilting stitches.
- Mixed techniques must have at least 2 techniques, i.e., piecing, applique, embroidery, trapunto, folding, etc.
- No hanging rods please.
- The State Fair reserves the right to move an entry to another class or combine with another class as needed.
- Entries must have been completed within the previous two years.

Bed Quilts – intended for use on a twin or full size bed

(UNDER 350” perimeter)

1. Pieced – Hand or Machine Quilted
2. Pieced – Professionally Quilted
3. Applique, Mixed, Special Techniques – Any Quilting Method

Bed Quilts – intended for use on queen or king size bed

(350” and OVER perimeter)

4. Pieced – Hand or Machine Quilted
5. Pieced – Professionally Quilted
6. Applique, Mixed, Special Techniques – Any Quilting Method

Throw/Lap/Child or Crib Quilts – intended for use as such

(UNDER 350” perimeter)

7. Pieced – Hand or Machine Quilted
8. Pieced – Professionally Quilted
9. Applique, Mixed, Special Techniques – Any Quilting Method

Large Wall Hanging – intended for use on a wall

(OVER 200” perimeter)

10. Pieced – Hand or Machine Quilted
11. Pieced – Professionally Quilted
12. Applique, Mixed, Special Techniques – Any Quilting Method

Medium Wall Hanging – intended for use on wall

(120” to 200” perimeter)

13. Pieced – Hand or Machine Quilted
14. Pieced – Professionally Quilted
15. Applique, Mixed, Special Techniques – Any Quilting Method

Small Wall Hanging – intended for use on wall

(UNDER 120" perimeter)

- 16. Pieced – Hand or Machine Quilted
- 17. Pieced – Professionally Quilted
- 18. Applique, Mixed, Special Techniques – Any Quilting Method

Miniature Quilt –

(UNDER 96" perimeter – maximum 24" per side)

Blocks must be 4" or less and a replica of a large pattern

- 19. Any technique

Household Items

- 20. Any technique, must include quilting (any table topper/runner, placemats, pillows, or kitchen accessory)

Holiday Theme

- 21. Any technique, must include quilting

Challenge Quilt

- 22. Local Quilt Challenge 2023-2024 year
(Include name of guild and challenge rules)

Group Quilt

- 23. Bed Quilt (include name of quilting group)

Memory/Album Quilt

- 24. Any technique, must include quilting

Hand-Tied Quilt

- 25. Any size, any technique, must include three layers (batting)

Special Surface Design Techniques

- 26. Includes cross stitch, yo yos, felt, embroidery, whole cloth, etc. (must include quilting)

Modern Quilt Design

A quilt using a new design or reinterpreted traditional design, including improvisational piecing, alternative block structures, or emphasis of negative space and asymmetry.

- 27. Pieced, any quilt, any quilting method

Display Only

- 28. Any size, any quilting method

Youth Division

- 29. Ages 10 and under (current age), any size, any quilting method
- 30. Ages 11 to 17 (current age), any size, any quilting method

Theme Division

- 31. Theme Class - (See Static Information on Page 48)

The following rosettes will be award in Quilting - Division M

- Best Youth Quilter
- Best Use of Color
- Best Quilt Technique
- Best of Division
- Best of Show

DIVISION N - ACCESSORIES

Hats must be made by hand, but may have a manufacturer's form or frame.

Premiums: \$13.50 • \$12.50 • \$11.50

CLASS

- 1. Apron, cobbler or full-length
- 2. Apron, hostess
- 3. Hat or Veil, brides
- 4. Tote bags
- 5. Purse, crocheted
- 6. Purse, knitted
- 7. Purse, other
- 8. Beadwork
- 9. Any other
- 10. Theme Class - (See Static Information on Page 48)

DIVISION O - HOME ACCESSORIES

Premiums: \$13.50 • \$12.50 • \$11.50

CLASS

- 1. Pillow, Crochet
- 2. Pillow, Crewel Embroidered
- 3. Pillow, Thread Count or Cross-Stitch
- 4. Pillow, Needlepoint
- 5. Pillow, Embroidered, Hand or Machine
- 6. Pillow, Latch Hook
- 7. Pillow, Knit
- 8. Pillow, Cloth, Sewn or Quilted
- 9. Pillow, Novelty
- 10. Kitchen/Dish Towels, (2) Embroidered, Hand
- 11. Kitchen/Dish Towels, (2) Embroidered, Machine
- 12. Kitchen/Dish Towels, (2) Applique
- 13. Kitchen/Dish Towels, (2) Novelty
- 14. Potholders, (2) Crochet
- 15. Potholders, (2) Knit
- 16. Potholders, (2) Cloth
- 17. Oven Mitts, (2) Cloth
- 18. Placemats, (2) Cloth
- 19. Napkins, (2) Cloth
- 20. Coasters, (4) Cloth
- 21. Mug Rug, (6" x 8" minimum) Cloth
- 22. Floor Rug, Crocheted, any size
- 23. Floor Rug, Hooked, any size
- 24. Floor Rug, Cloth, any size
- 25. Wool Item, any size
- 26. Any other
- 27. Theme Class - (See Static Information on Page 48)

Best Youth Quilter
sponsored by:
Bernina Plus
Bernina Plus will offer a
\$30 Gift Certificate to the
Youth Quilter
Division M - Class 29 & 30



104 Main Street South
Minot, ND 58701
(701) 837-5638

DIVISION P - SEASONAL/HOLIDAY HOME DECORATION

Premiums: \$13.50 • \$12.50 • \$11.50

CLASS

1. Tablecloth or Luncheon Cloth
2. Christmas Tree Skirt
3. Christmas Stocking
4. Christmas Tree Ornament (1)
5. Christmas Ornament (not tree)
6. Seasonal Centerpiece or Table Runner, cloth
7. Wreath, any season
8. Valentine's Day Item
9. Halloween Item
10. Thanksgiving Item
11. Easter Item
12. Patriotic Item
13. Wool Item, any season
14. Any other seasonal/holiday item
15. Theme Class - (See Static Information on Page 48)

DIVISION Q - LARGE PICTURES

(Framed, Over 12" stitched design)

Premiums: \$14.50 • \$13.50 • \$12.50

CLASS

1. Crewel Embroidery
2. Embroidery (not wool yarn)
3. Needlepoint
4. Printed Cross Stitch
5. Counted Cross Stitch
6. Hardanger
7. Any other
8. Theme Class - (See Static Information on Page 48)

DIVISION R - MEDIUM PICTURES

(Framed, 8" to 12" stitched design)

Premiums: \$13.50 • \$12.50 • \$11.50

CLASS

1. Crewel Embroidery
2. Embroidery (not wool yarn)
3. Needlepoint
4. Printed Cross Stitch
5. Counted Cross Stitch
6. Hardanger
7. Any other
8. Theme Class - (See Static Information on Page 48)

DIVISION S - SMALL PICTURES

(Framed, Up to 8" stitched designs)

Premiums: \$13.50 • \$12.50 • \$11.50

CLASS

1. Crewel Embroidery
2. Embroidery (not wool yarn)
3. Needlepoint
4. Printed Cross Stitch
5. Counted Cross Stitch
6. Hardanger
7. Any other
8. Theme Class - (See Static Information on Page 48)

DIVISION T - WALL HANGINGS

(Unframed, any size)

Premiums: \$13.50 • \$12.50 • \$11.50

CLASS

1. Embroidery (not wool yarn)
2. Crewel Embroidery
3. Crocheted
4. Latch Hook
5. Needlepoint
6. Counted Cross Stitch
7. Hardanger
8. Any other method
9. Theme Class - (See Static Information on Page 48)

DIVISION U - ORIGINALS

(Exhibitor's Own Creation & Design)

Premiums: \$14.50 • \$13.50 • \$12.50

CLASS

1. Crewel Embroidery
 2. Crocheted
 3. Counted Cross Stitch
 4. Embroidery (not wool yarn)
 5. Hardanger
 6. Latch Hook
 7. Needlepoint
 8. Any other method
 9. Theme Class
- (See Static Information on Page 48)

DIVISION V - CONTESTS

CLASS

1. Machine Embroidery Contest



Machine Embroidery Contest

Vacuum & Sewing Center of Minot will sponsor the Machine Embroidery Contest. Your imagination and creativity will determine the winner of this contest. Some ideas are embroidered landscape on garment, embroidery on a quilt, machine cross-stitch, or whatever you like, as long as it is embroidered. The contest will be judged on the use of your imagination. The more unique the better! Winners will receive a gift card for any product at Vacuum Sewing center of Minot.

1st Place - \$25 Gift Card
2nd Place - \$20 Gift Card
3rd Place - \$15 Gift Card

In this category, you are only judged on your embroidery. The item you embroider will have no influence on your placing

Department 114 - Photography

Superintendent: Taube Museum of Art

Photography Schedule

	<u>Drop Off</u>	<u>Judging</u>	<u>Pickup</u>
All Photography Exhibits	Thursday - 7/6 - 8am-5pm	Wednesday - 7/17	Saturday - 7/27 - 6-8pm
			Sunday - 7/28 - 10am-2pm

Deadline for entry form is July 6, 2024. Open Class Photography may be brought to 4-H Hall in the ND State Fair Center.

ENTRY FEE: Division A & B: \$1/class
Division C: \$1/exhibitor

RULES ON ENTERING:

- Entries must be listed on an official entry form by July 6. Due to our computer entry program, we encourage you to mail your entry form in early. There is also an online entry option that can be found on ndstatefair.com. Fair management is not bound to accept entries made after the deadline.
- Please clearly print name, address, department, division, and class on the entry form, as well as on the sample being exhibited. Exhibits cannot be accepted unless an entry blank is properly filled out and on file with the Fair Office prior to the closing date for entries.
- Use separate entry blanks for each department (i.e. flowers, needlework, etc.).
- Competition is open to North Dakota residents only.
- Entry form must include the title of each exhibit being entered. Attach entry information to work with tape.
- Please enter exhibit under person's name who made it
- All reasonable care will be given to exhibits entered. The North Dakota State Fair and the Taube Museum of Art will not be responsible for any loss or damage during transit, judging or exhibition. Submission of entry implies acceptance of and compliance with these conditions and regulations.
- Unless exhibits comply with these rules, they will not be accepted.

RULES ON DROPPING OFF:

- Any article, having been properly entered, can be forwarded by mail or prepaid express to Dept. 114, ND State Fair, PO Box 1796, Minot, ND 58702, where it will then be placed on exhibition. The management however, will not be responsible for any breakage of glass or loss of any article. A self-addressed label and return postage must accompany the exhibit for return. The ND State Fair will assume no responsibility for return of exhibit with insufficient postage. Send complete list of articles contained in package. Mailed exhibits must reach the Fair Office no later than 5pm **Friday, July 5.**
- No entries will be accepted after deadline. Judging will begin Wednesday, July 17 at 1:30pm.
- All entries must be in a sack, package, box, etc., for protection and return.

JUDGING CRITERIA:

- The judges are instructed not to award prizes unless the articles are deemed of real merit, even though they may be the only entry in the class.
- Any article exhibited in prior years at the North Dakota State Fair is ineligible to show
- The Acceptance Committee will review all exhibits for eligibility for judging, and for display if space is limited. All prize winners will be displayed. Unworthy entries will not be awarded places or displayed.

RULES ON PICKING UP:

- Exhibits will not be released before 6pm on the last day. Exhibits may be picked up on Saturday, July 27 between the hours of 6pm and 8pm or on Sunday, July 28 between the hours of 10am and 2pm. Claim checks must be shown before release. The building will be closed at 8pm Saturday, July 27. Those picking up exhibits Saturday must pay gate admission.

Cash awards will be mailed September 2024

Best of Division:

One Best of Division Rosette will be awarded in each division of this department.

Best of Show:

One Best of Show Award will be given in the Needleworks Department.

SPECIFICATIONS FOR PRINT

(Black/White and Color)

- Minimum size of print 8"x10", maximum size of mount 16"x20" (including frame).
- All photos must be covered in some way - plastic, acetate or shrink wrap. No LOOSE photos or photos with glass will be accepted.
- All photos must be matted. No corrugated cardboard, masonite, poster board, etc. Mount may be same size as print, but may not be larger than 16" x 20". Only one print per mount.
- Place hanger on back of mount (see diagram), centered 2" from top. Reinforce hanger with strapping tape. Photos are hung for the entire fair, and must be ready to hang. Due to the nature of our facility, do not use tape, string or any type of metal hook. Saw tooth hangers will be allowed on framed pictures only.
- Photographer's name, address, print title, Division and Class number must be on the back of the mount.

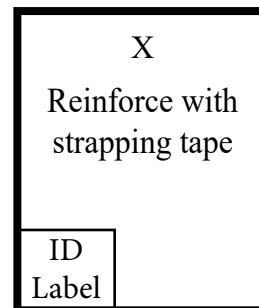

Definitions (Amateur and Junior):

- **Scenes:** A view, landscape, seascape, etc.
- **Portraits:** Recognizable likeness of a person or persons.
- **Pure Nature:** Wild flowers, wild animals, etc. Prints of stuffed animals and museum sets will not be accepted. Nature subjects should not include the handiwork of man (roads, buildings, cultivated plants, domesticated animals, etc.)
- **Domestic Nature:** Animals, pets and cultivated flowers.
- **Photojournalism:** Picture that tells a story.
- **Still Life / Contemporary:** An arrangement of inanimate objects or creative or imaginative departure from reality.
- **North Dakota State Fair:** Must have been taken at the 2022 or 2023 ND State Fair of educational, livestock, produce, commercial exhibits, human interest scenes, or Carnival Midway. The State Fair Board reserves the right to use any of this lot for advertising purposes, with exhibitor retaining ownership of print. (Three State Fair and three carnival pictures may be entered).
- **Miscellaneous:** Must not fit in any other category.

Premiums

- **Classes:** \$19.00 • \$16.00 • \$14.00 • **HM: Ribbon** • **Best of Division:** \$23.00 and special ribbon

SECTION ONE - AMATEUR PHOTOGRAPHY

Entry Fee: \$1.00 per class (Limit 4 entries per class)

Amateur Rules and Information:

1. Competition open to **amateur** photographers, residents of North Dakota.
2. Photography **must** have been taken by the exhibitor. All work must have been completed in the past year and must not have been previously entered at the ND State Fair.
3. Exhibitors may have no more than four (4) entries in any class, except State Fair classes, which may have six (6).

DIVISION A - COLOR PRINTS

CLASS

- | | |
|---------------------------------|--|
| 1. Scenics | 6. Photojournalism |
| 2. Portraits | 7. Still Life/Contemporary |
| 3. Pure Nature | 8. North Dakota State Fair/
Carnival Midway |
| 4. Domestic Nature -
Animals | 9. Miscellaneous |
| 5. Domestic Nature -
Flowers | 10. Theme Class - (See Static
Information on Page 48) |

DIVISION B - BLACK/WHITE OR SEPIA PRINTS

CLASS

- | | |
|------------------------------|--|
| 1. Scenics | 6. Still Life/Contemporary |
| 2. Portraits | 7. North Dakota State Fair/
Carnival Midway |
| 3. Pure Nature | 8. Miscellaneous |
| 4. Domestic Nature - Pets | 10. Theme Class - (See Static
Information on Page 48) |
| 5. Domestic Nature - Flowers | |
| 6. Photojournalism | |

SECTION TWO- JUNIOR PHOTOGRAPHY

Entry Fee: \$1.00 per exhibitor

Junior Rules and Information:

1. Competition open to **junior** photographers, age 15 and under. Include birthdate on your entry blank by your name
2. Limit two (2) entries per class.
3. Print specifications apply.

DIVISION C - JUNIOR

CLASS

1. Scenics
2. Nature – Domestic or Wild
3. People
4. Photojournalism
5. Miscellaneous
6. Theme Class - (See Static Information on Page 48)



Education Department

Superintendent: Lori Olson

<i>Education Department Schedule</i>		
	<u>Drop Off</u>	<u>Pickup</u>
All Education Exhibits	May 15 - July 5	Saturday - 7/27 - 6-8pm
		Sunday - 7/28 - 10am-2pm

Those picking up exhibits Saturday must pay gate admission. NDSF is not responsible for exhibits after August 2, 2024.

1. Obtain tags and entry forms by calling 701-857-7620 or download them at www.ndstatefair.com
2. Complete the entry form
 - Under contact name list the teacher or school administrator and a phone number.
 - Complete the entry form with a list of Fair exhibits; specify if these are County Fair Blue Ribbon winners.
 - **Please enter Elementary, Middle School, High School and Home School on separate sheets.**
3. Select School Class, Grade Class, and Division from the box below.
4. Follow the guidelines on the back for Mounting, Display, Showmanship, and Stability.
5. Complete the entry tag
 - Label entry tag: School Classification, Grade Class, Division, County, School, Teacher, & Student Name
 - Example: An exhibit of penmanship by a first-grade child in a school with 200 students.
 - School Class – A Grade– P Division – 1 Entry No. – Leave blank
 - If more than one student completes the entry, indicate on the entry tag or form how many students were involved in the project so all may receive ribbons.
 - Attach entry tags SECURELY to each entry where they can easily be seen.
6. **Send or bring exhibits to the State Fair Office from May 15 through July 7.** If mailed, mark packages Education Dept. Provide return instructions for exhibits. (i.e., COD, adequate return postage enclosed)
7. **Pickup exhibits between 6pm and 8pm on Saturday, July 27 (you MUST pay the \$12 gate admission) OR Sunday, July 28 between 10am and 2pm. Exhibits not picked up at these designated times may be obtained by calling the NDSF office. NDSF is not responsible for any exhibits left after August 2, 2024.**
8. Receive cash and ribbons
 - All schools receiving more than \$1.00 in premiums (cash prizes) will be mailed a check in September 2024
 - First place (Blue ribbon) - \$1.75; Second place (Red ribbon) - \$0.75; Third place (White ribbon) - \$0.50.
 - Premiums will be paid for school classification only. Example: Class A enters 35 exhibits and receives 20 blue, 10 red, and 5 white ribbons. Premiums will be paid on the 20 blues and 10 reds. (Class A = limit 30 entries)



CRITIQUE

(Please send a school sign to put with your display items)



1. MOUNTING

- No more than eight exhibits on a tag board.
- Lettering should be well planned, balanced and attractive.
- Same quality of work should be mounted together in any one display.
- Student's names should be visible on display.
- **Only one entry tag per board is needed.**
- Please remove all county fair ribbons.

2. DISPLAY

- Select the BEST work for display and not the work of the entire class, e.g., 20 students draw sketches: only the best should come to the Fair, other students may enter another project.
- Science projects need art and language skills for proper presentation.
- Use Showmanship in all displays (see below).
- Do not display small projects on extremely large bases.

3. SHOWMANSHIP

- Explanations in the form of 3 x 5 cards may be necessary.
- Include the special circumstance and history of the project.

4. STABILITY

- Construct projects so they will not fall apart in normal handling and transportation.

Obtain tabs and entry forms online at www.ndstatefair.com or by calling 701-857-7620.

Questions? Email Superintendent Lori Olson: lori.olson@minot.k12.nd.us

SCHOOL CLASS:

Entry Premium Limit

- CLASS A 30 entries/elementary school-under 400 students
- CLASS B 40 entries/elementary school-400 students & over
- CLASS C 30 entries/middle or junior high school-under 400 students
- CLASS D 40 entries/middle or junior high school-400 students & over
- CLASS E 30 entries/high school-under 400 students
- CLASS F 40 entries/high school-400 students & over
- CLASS G 30 entries/home school

DIVISIONS:

What projects will you submit?

1. Handwriting
2. Illustrated Booklets
3. Special Study Projects:

a. Science	b. North Dakota
c. Social Studies	d. Collections
4. Creative / Visual Arts:

a. Drawing	f. Sculpture
b. Painting	g. Weaving
c. Photography	h. Computer Art
d. Pottery	i. Pen and Ink
e. Printmaking	j. Three Dimensional
5. Holiday Art/Craft
6. Original Writing
7. Computer Projects
8. Recycled Art – Made from recycled Items
9. Open – Any project not listed

GRADE CLASS:

What grade are your students?

- K - Kindergarten
- P - Grades 1, 2, 3
- I - Grades 4, 5, 6
- MS - Grades 6, 7, 8 or 7, 8, 9
- HS - Grades 9, 10, 11, 12
- SN - Special Needs



2024
North Dakota State Fair
July 19 - 27

WRITING CONTEST

WRITING CONTEST—Best of Show: \$150	<i>Best of Division</i>	<i>1st</i>	<i>2nd</i>	<i>3rd</i>	<i>4th</i>	<i>Hon. Mention</i>
Division A (<i>Junior: Ages 13 or younger on July 19</i>)	\$35.00	\$25.00	\$20.00	\$10.00	\$10.00	\$6.00
Division B (<i>Young Adult: Ages 14–20 on July 19</i>)	\$40.00	\$30.00	\$20.00	\$15.00	\$10.00	\$6.00
Division C (<i>Adult: 21 or older on July 19</i>)	\$100.00	\$75.00	\$50.00	\$35.00	\$20.00	\$10.00

HERITAGE CONTEST – Best of Show: \$150						
Division D (<i>Ages 20 or younger on July 19</i>)	\$45.00	\$30.00	\$20.00	\$15.00	\$10.00	\$5.00
Division E (<i>Adult: Ages 21 or older on July 19</i>)	\$50.00	\$40.00	\$30.00	\$20.00	\$10.00	\$5.00

Cash awards will be mailed September 2024.

People living in North Dakota have had an opportunity each year since 1976 to enter their writings in the ND State Fair Writing Contest. Work submitted will be displayed in the 4-H Hall in the ND State Fair Center during the 2024 North Dakota State Fair (July 19-27). In addition to the ND State Fair, support for the contest comes from Minot State University and the Northern Plains Writing Project. Please indicate which contest and category you are entering.

The Rules:

1. Each North Dakota resident may enter up to three works in any form (short stories, poems, plays, essays, letters, diaries, etc.). Maximum length for a work is 2,500 words.
2. Writer's name, address, and division **MUST BE** on the first page of each manuscript in the upper right-hand corner. If a return address is out-of-state, the writer should enclose a written explanation of residency. Please punch a hole in the upper left-hand corner of all manuscripts for hanging in the display.
3. Writers 13 years of age or younger on July 19, 2024, will compete in Division A. Writers 14 through 20 years of age on this day will compete in Division B, and writers 21 years of age and older on this day will compete in Division C. A writer competing in Division A or B should write his or her age as of July 19 on the first page of the manuscript.
4. Manuscripts should be sent to the North Dakota State Fair Writing Contest, Box 1796, Minot, ND 58702 or by email to competitive@ndstatefair.com. All entries must be in the Fair office by July 6, 2024.
5. Submission of a manuscript gives the officials of this contest and of the State Fair permission to display the manuscript in the 4-H Hall during the 2024 North Dakota State Fair. If sufficient funding is received, efforts will be made to publish winning manuscripts in an anthology, or to offer the manuscripts for publication in North Dakota weekly and daily newspaper. All other rights remain with author.
6. Photocopied manuscripts can be submitted. Manuscripts will not be returned. Officials and institutions associated with this contest assume no responsibility for lost or damaged manuscripts. Judging will be done by teacher-consultants of the Northern Plains Writing Project. All decisions of the judges are final.
7. Comments about the Writing Contest are encouraged from participants. Please address comments to: Samuel Stinson, ND State Fair Writing Contest, Division of Humanities, Minot State University, Minot ND 58707.

THE HERITAGE CONTEST

The North Dakota Heritage Contest exists so people might write down and submit their own stories about what life was like in North Dakota. Work submitted will be displayed in the 4-H Hall in the ND State Fair Center during the 2024 North Dakota State Fair (July 19-27). The contest is sponsored by the North Dakota State Fair. Additional support comes from Minot State University and the Northern Plains Writing Project. Please indicate which contest and category you are entering.

The Rules:

1. Each North Dakota resident may enter up to three works which illustrate aspects of North Dakota's culture and heritage. Here are a few of the many possible topics: attending a one-room school, being snowbound during a blizzard, working in a blacksmith shop, coming home after a war, going to town on Saturday night, and moving from farm to town.
2. Personal reminiscences, interviews with people who have lived in the state, or pieces of writing based on letters, diaries, and other old documents are all acceptable. Maximum length for a work is 2,500 words. Judges will look for quality of writing, relevance to the history and culture of North Dakota, and human interest when judging works entered.
3. Writer's name, address, and division **MUST BE** on the first page of each manuscript in the upper right-hand corner. If a return address is out-of-state, the writer should enclose a written explanation of residency. Please punch a hole in the upper hand corner of all manuscripts for hanging in the display.
4. Writers 20 years of age or younger on July 19, 2024, will compete in Division D. Writers 21 years of age and older on this day will compete in Division E. A writer competing in Division D should his or her age as of July 21 on the first page of the manuscript.
5. Manuscripts should be sent to the North Dakota State Fair Heritage Contest, Box 1796, Minot, ND 58702 or by email to competitive@ndstatefair.com. All entries must be in the Fair office by July 6, 2024.
6. Submission of a manuscript gives the officials of this contest and of the State Fair permission to display the manuscript in the 4-H Hall during the 2023 North Dakota State Fair. If sufficient funding is received, efforts will be made to publish winning manuscripts in an anthology, or to offer manuscripts for publication in North Dakota weekly and newspapers. All other rights remain with the author.
7. Photocopied manuscripts can be submitted. Manuscripts will not be returned. Officials and institutions associated with contest assume no responsibility for lost or damaged manuscripts. Judging will be done by teacher-consultants of the Northern Plains Writing Project. All decisions of the judges are final.
8. Comments about the Heritage Contest are encouraged from participants. Please address comments to: Samuel Stinson, State Fair Writing Contest, Division of Humanities, Minot State University, Minot, ND 58707.

2024



THANK YOU to our 2024 NDSF Competitive Exhibit Sponsors!





NORTH DAKOTA STATE FAIR ASSOCIATION
PO Box 1796
Minot, ND 58702-1796

PRSR STD
US POSTAGE
PAID
BISMARCK, ND
PERMIT NO 433

Get your FAiR on!



MINOT, ND
NDStateFair.com